

# CLASSIC 40M BENETTI

---





CLASSIC 40M BENETTI

# SPÉCIFICATIONS.



Prix demandé  
EUR 6 000 000



Chantier  
1970 (refitted 2022), Benetti, Italy



Longueur  
39,5m



Largeur  
7,4m



Tirant d'eau  
3m



Tonnage brut  
267



Vitesse de croisière  
11 knots



Vitesse maximale  
13 knots



Autonomie  
3 600 nm



Pavillon  
United Kingdom



Position  
West Mediterranean



Classe  
Bureau Veritas



Designer extérieur  
Benetti



Construction  
Hull - Steel, Superstructure - Steel



Équipage  
7



Invités  
8



Cabines  
4 (2 x double, 2 x twin)



Propulsion  
Twin screw diesel yacht

[Voir le yacht sur le site](#)

[Regarder la vidéo du yacht](#)





CLASSIC 40M BENETTI









CLASSIC 40M BENETTI



BURGESS

Discover the difference.  
burgessyachts.com





CLASSIC 40M BENETTI





CLASSIC 40M BENETTI



BURGESS

Discover the difference.  
burgessyachts.com





CLASSIC 40M BENETTI



BURGESS

Discover the difference.  
burgessyachts.com





CLASSIC 40M BENETTI





CLASSIC 40M BENETTI





CLASSIC 40M BENETTI

# APERÇU.

A handsome yacht with a first-class pedigree, CLASSIC 40M BENETTI is a 39.5m (129.5ft) tri-deck motor yacht constructed in steel with aluminium superstructure and delivered by the renowned Italian shipyard in 1970. Her long-standing owner has kept a tight maintenance schedule, ensuring that each winter the yacht is refitted and refurbished as needed.

Exterior design details include a graceful sheer line and bow profile, a classic canoe stern, full walkaround sidedecks on two levels and traditional varnished teak capping rails. Covered companionways on the main deck feature Benetti's signature sculpted mullions.

The sun deck has L-shaped sofa seating and a huge expanse of sunpads with partial shade from a fixed awning and exercise equipment forward either side of the funnel. There is another large sunpad forward on the bridge deck and steps down to cushioned seats overlooking the foredeck.

She has a spacious bridge deck aft with shaded open-air dining beneath the sun deck overhang and a sun lounge with a sofa, armchairs and a coffee table opposite two sun loungers. There's a sociable seating area aft that serves as a second open-air dining option with a U-shaped banquette, folding armchairs, a large high-gloss varnished table and a folding canvas bimini.

The main deck aft has four large rattan armchairs around a coffee table in ample shade. Inside, her interior decor is traditional, with finely crafted features. The main deck saloon has a large lounge area aft with L-shaped sofas and two armchairs and forward is the formal dining area with an eight-seat table. The sky lounge has a large sofa facing aft, looking through double doors opening onto the upper aft deck.

Welcoming up to eight guests in four cabins with seven crew, CLASSIC 40M BENETTI offers 267GT of internal volume. The guest accommodation is arranged across two decks. The owner's suite is forward on the main deck, has an office desk and a 10sqm (108sqft) walk-in wardrobe. The en suite has a bathtub as well as a shower. The other guest cabins are on the lower deck, comprising a full-beam VIP double forward and two twin cabins that each have extra pullman berths.

This twin-screw yacht is powered by twin 624hp Caterpillar diesel engines with low engine hours. Her top speed is 13.7kts and she cruises at 11.5kts with a maximum range of 3,600nm.

## Principales caractéristiques

---

Steel hull and Aluminium superstructure

---

Classic yacht with canoe stern

---

Lovingly maintained and refitted

---

Cruising ready

---



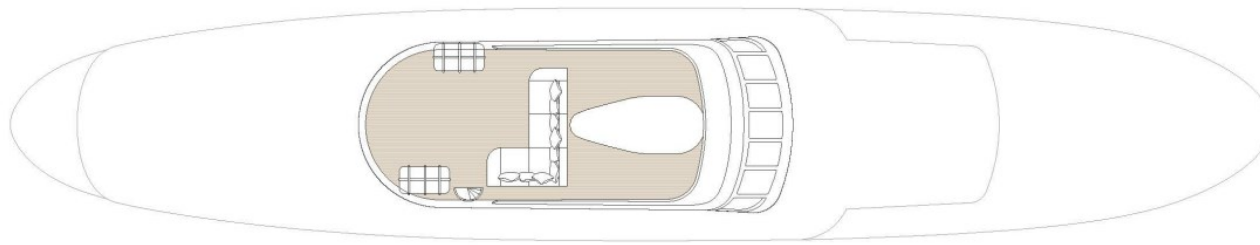

SUN DECK

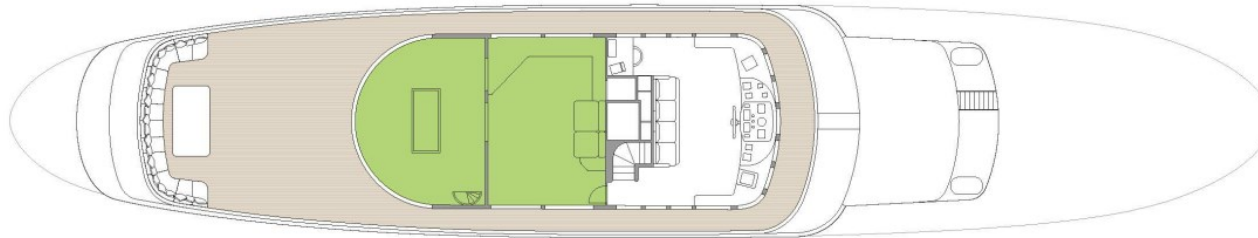

BRIDGE DECK



MAIN DECK

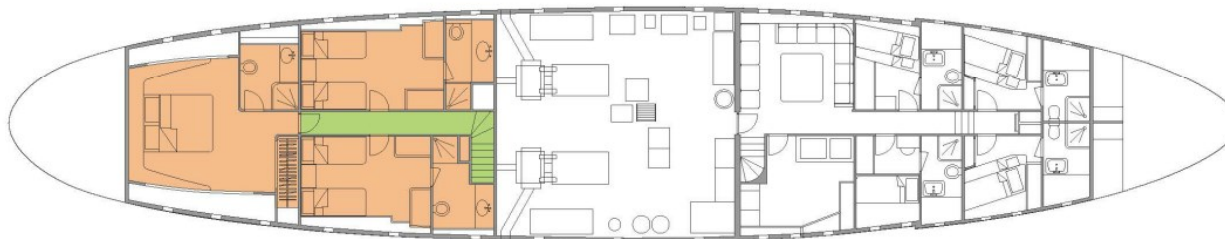

BELOW DECK

■ GUEST AREAS ■ MASTER SUITE ■ GUEST CABINS



BURGESS

WORLD CLASS.  
WORLD WIDE.

London +44 20 7766 4300	Monaco +377 97 97 81 21	New York +1 212 223 0410	Miami +1 305 672 0150	Singapore +65 9665 8990	Beverly Hills +1 310 424 5112	Palma +34 971 495 413	Athens +30 210 967 1661
	Dubai +971 4 425 5874	Phuket +66 7623 9739	Hong Kong +852 6496 2094	Tokyo +81 46 738 8612	Sydney +61 499 945 557	Mumbai +91 98211 67253	

La publicité de ce(s) navire(s) dans des publications imprimées, sur Internet ou sur tout autre support n'est pas autorisée sans l'autorisation écrite préalable de Burgess.  
Toutes les informations sont données de bonne foi et sont considérées comme exactes, mais elles ne peuvent être garanties.

Dernière mise à jour : 11 avril 2024