

# CHARADE

---



CHARADE

# APERÇU.

**CHARADE's stand-out contemporary interiors were lovingly crafted by British studio, RWD. Emphasis was placed on creating a serene, yet lush and light interior feel. Very much a calm haven that in no way takes away from her sporty and sharp exterior coined by Stefano Righini. With stabilisers both at zero-speed and underway, powerful twin MTU engines and an ability to cruise between 17.5 and 22 knots, CHARADE promises a tranquil, smooth passage from location to location, with no compromise on speed.**

CHARADE invites you to bask in the inviting embrace of abundant natural light that streams through the expansive floor-to-ceiling windows, enveloping the yacht's main living spaces. Meticulous attention to lighting during the design phase has resulted in the use of elegant slim light panels throughout the yacht's interior. Moreover, the exterior RGB lighting system awaits your command, ready to cast the yacht in a captivating array of colours, setting the perfect mood for your journey.

## Principales caractéristiques

---

**Hydraulic swim platform**

---

**Shaded deck dining and deck areas**

---

**Jacuzzi on the bow**

---

**Zero speed stabilisers to reduce any rolling motion while at anchor**

---

**Exercise equipment**

---



# CHARADE

At anchor



At anchor



At anchor



Sun deck





# CHARADE

Sun deck



# Foredeck



# Foredeck



# Upper deck dining

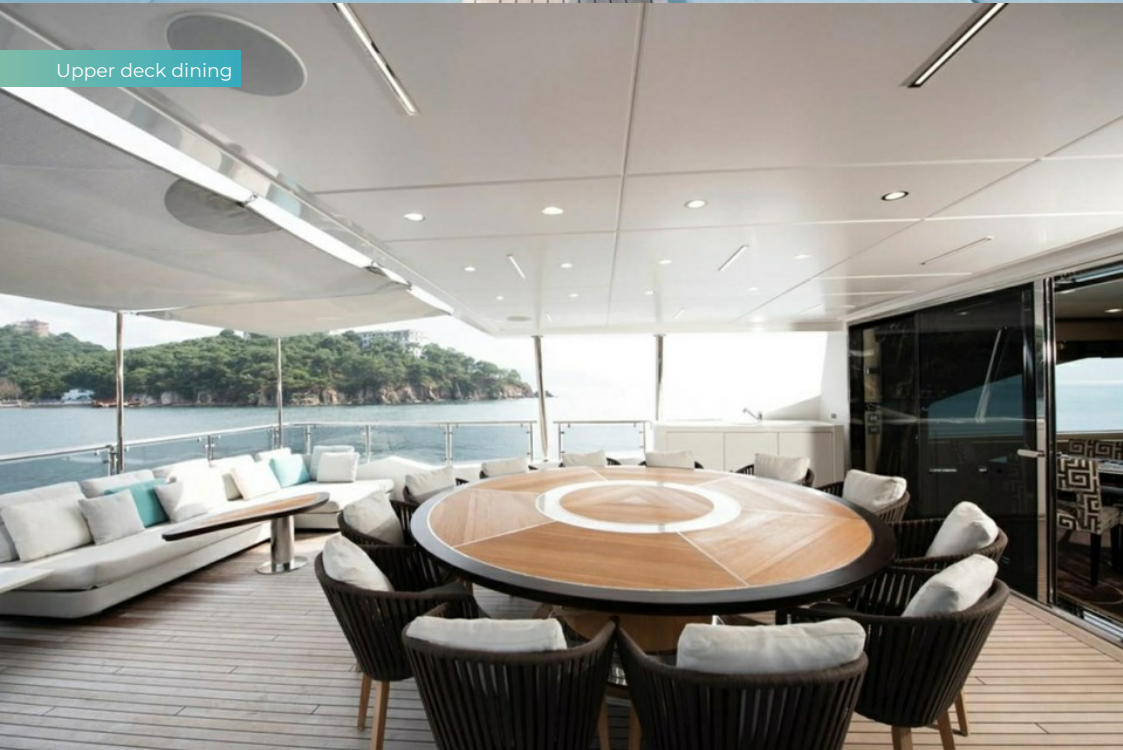



# CHARADE

Upper deck dining



Main deck aft



Main deck aft



Main deck lounge





# CHARADE

Main deck lounge



Main deck dining



Upper deck lounge



Upper deck lounge





# CHARADE

Main deck master cabin



Main deck master cabin



Master bathroom en suite



Lower deck VIP cabin





# CHARADE

Lower deck VIP cabin



Lower deck twin cabin



Swim platform





CHARADE

# SPECIFICATIONS.



Longueur  
**38,1m**



Chantier  
**2018, Benetti, Italy**



Designer d'intérieur  
**Stefano Righini**



Largeur  
**8,2m**



Tirant d'eau  
**1,9m**



Tonnage brut  
**349**



Vitesse de croisière  
**18 knots**



Vitesse maximale  
**24 knots**



Moteurs  
**2 x 2 600hp MTU**



Invités  
**10**



Nb de cabines invités  
**5 (3 x double, 2 x twin)**



Équipage  
**8**

[Voir le yacht sur le site](#)





CHARADE

# ANNEXES & JEUX NAUTIQUES



1 x Tender



2 x Waverunners



2 x Stand up jetskis



4 x SeaBobs



1 x eFoil



2 x Stand up paddleboards



Wakeboard



Waterskis



Inflatable tows



CHARADE

# REMISE EN FORME & BIEN-ETRE



Free weights



Yoga mats





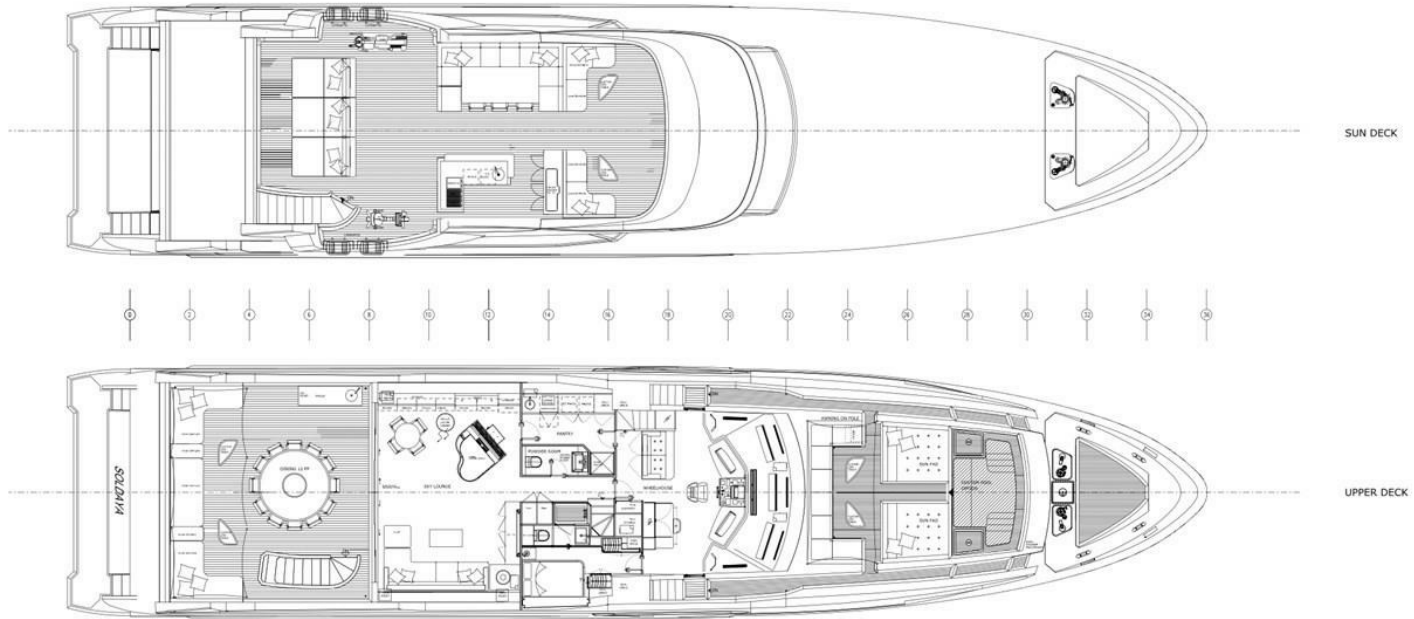



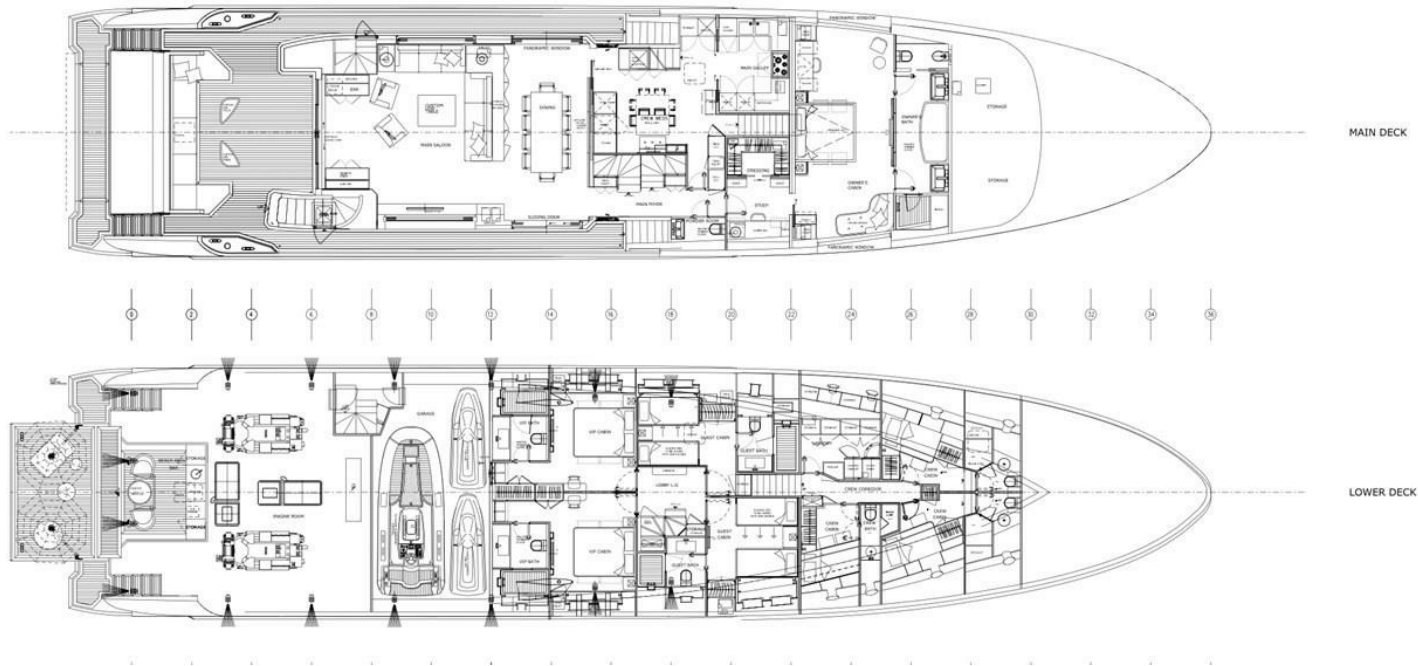



# BURGESS

# WORLD CLASS. WORLD WIDE.

<b>London</b> +44 20 7766 4300	<b>Monaco</b> +377 97 97 81 21	<b>New York</b> +1 212 223 0410	<b>Miami</b> +1 305 672 0150	<b>Singapore</b> +65 9665 8990	<b>Beverly Hills</b> +1 310 424 5112	<b>Palma</b> +34 971 495 413	<b>Athens</b> +30 210 967 1661
<b>Dubai</b> +971 4 425 5874	<b>Phuket</b> +66 7623 9739	<b>Hong Kong</b> +852 6496 2094	<b>Tokyo</b> +81 46 738 8612	<b>Sydney</b> +61 499 945 557	<b>Mumbai</b> +91 98211 67253	<b>Shanghai</b> +86 187 0898 6800	<b>Rio de Janeiro</b> +55 21 2553-3238
<b>Aspen</b> +1 970 710 2294							

La publicité de ce(s) navire(s) dans des publications imprimées, sur Internet ou sur tout autre support n'est pas autorisée sans l'autorisation écrite préalable de Burgess.  
Toutes les informations sont données de bonne foi et sont considérées comme exactes, mais elles ne peuvent être garanties.

Dernière mise à jour : 11 février 2025