

# CHARADE



CHARADE

# OVERVIEW.

**CHARADE's stand-out contemporary interiors were lovingly crafted by British studio, RWD. Emphasis was placed on creating a serene, yet lush and light interior feel. Very much a calm haven that in no way takes away from her sporty and sharp exterior coined by Stefano Righini. With stabilisers both at zero-speed and underway, powerful twin MTU engines and an ability to cruise between 17.5 and 22 knots, CHARADE promises a tranquil, smooth passage from location to location, with no compromise on speed.**

CHARADE invites you to bask in the inviting embrace of abundant natural light that streams through the expansive floor-to-ceiling windows, enveloping the yacht's main living spaces. Meticulous attention to lighting during the design phase has resulted in the use of elegant slim light panels throughout the yacht's interior. Moreover, the exterior RGB lighting system awaits your command, ready to cast the yacht in a captivating array of colours, setting the perfect mood for your journey.

## Key features

---

**Hydraulic swim platform**

---

**Shaded deck dining and deck areas**

---

**Jacuzzi on the bow**

---

**Zero speed stabilisers to reduce any rolling motion while at anchor**

---

**Exercise equipment**

---

# CHARADE

At anchor



At anchor



At anchor



Sun deck



# CHARADE

Sun deck



# Foredeck



# Foredeck



# Upper deck dining

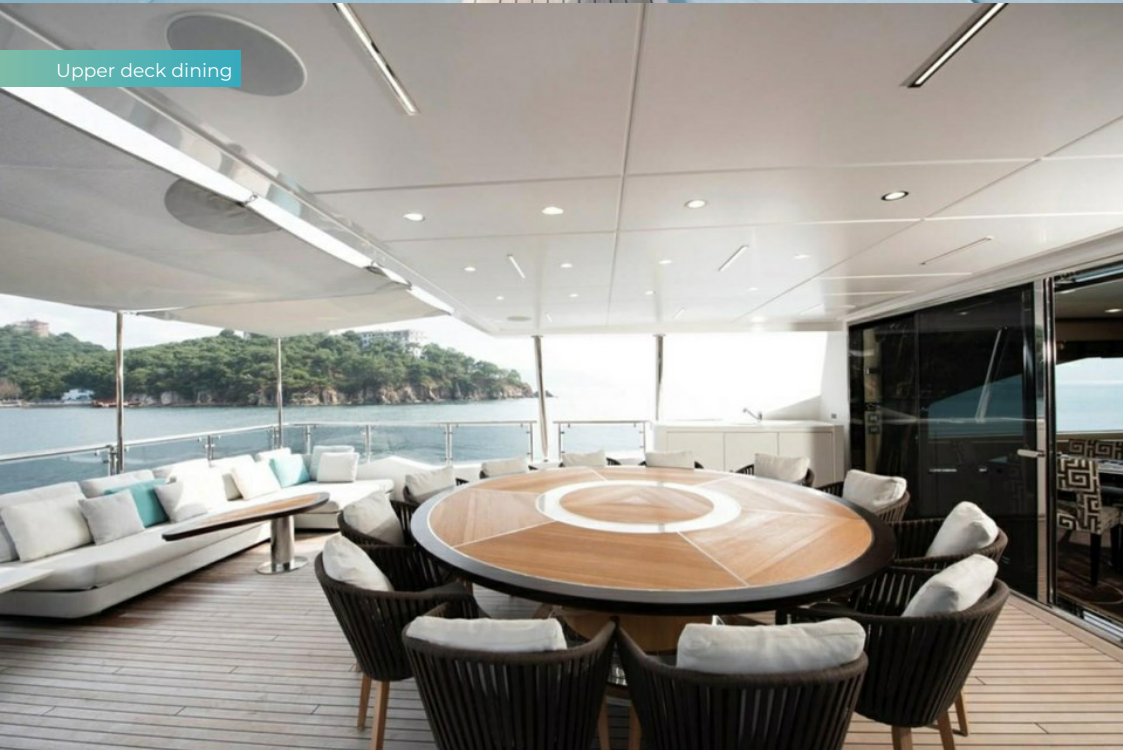

# CHARADE

Upper deck dining



Main deck aft



Main deck aft



Main deck lounge



# CHARADE

Main deck lounge



Main deck dining



Upper deck lounge



Upper deck lounge



# CHARADE

Main deck master cabin



Main deck master cabin



Master bathroom en suite



Lower deck VIP cabin



# CHARADE

Lower deck VIP cabin



Lower deck twin cabin



Swim platform





CHARADE

# SPECIFICATION.



Length  
**38.1m (125ft)**



Built  
**2018, Benetti, Italy**



Interior designer  
**Stefano Righini**



Beam  
**8.2m (26.9ft)**



Draft  
**1.9m (6.2ft)**



Gross tonnage  
**349**



Cruising speed  
**18 knots**



Maximum speed  
**24 knots**



Engines  
**2 x 2,600hp MTU**



Guests  
**10**



No. of guest cabins  
**5 (3 x double, 2 x twin)**



Crew  
**8**

[View yacht on website](#)



CHARADE

# TENDERS & TOYS



1 x Tender



2 x Waverunners



2 x Stand up jetskis



4 x SeaBobs



1 x eFoil



2 x Stand up paddleboards



Wakeboard



Waterskis



Inflatable tows

CHARADE

# FITNESS & WELLNESS



Free weights



Yoga mats



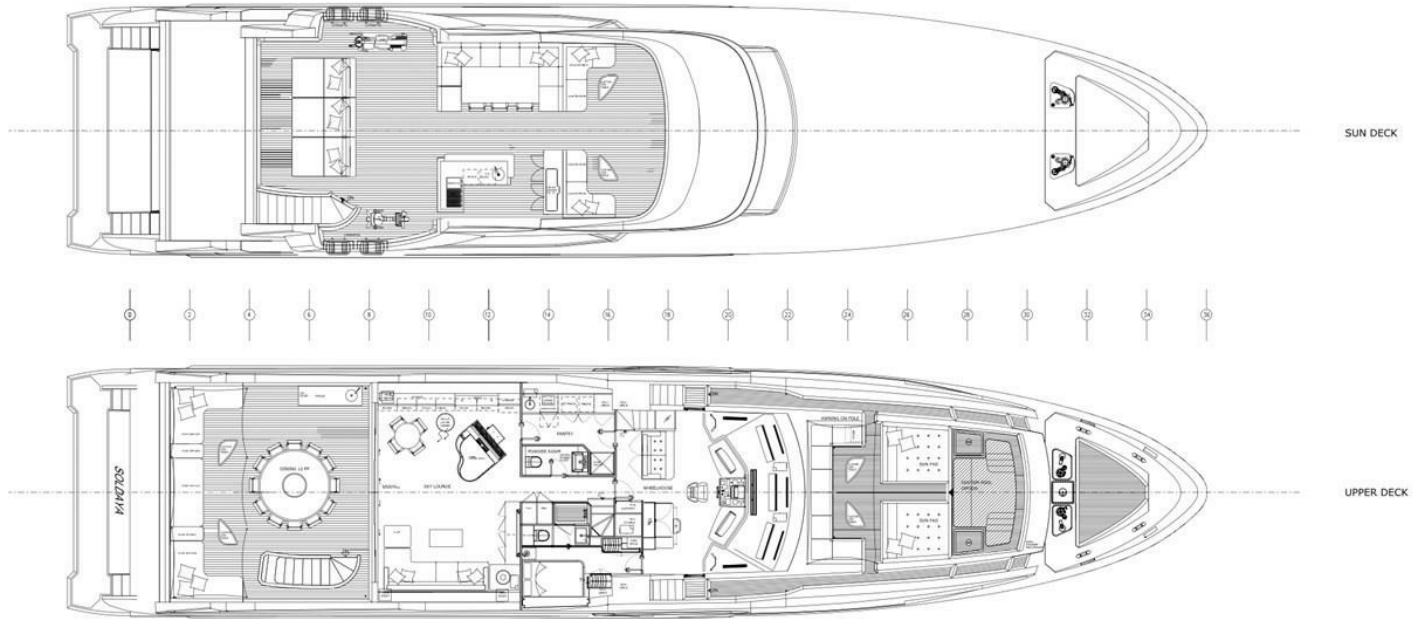

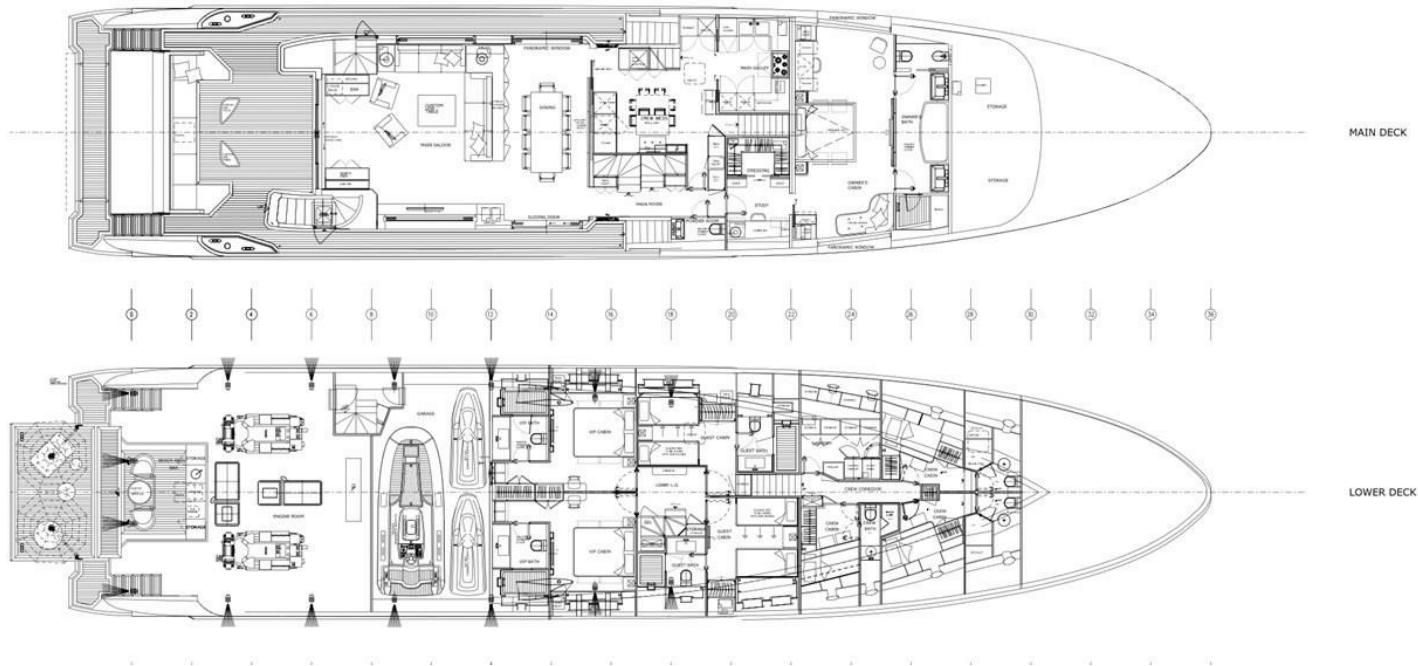

# BURGESS

# WORLD CLASS. WORLD WIDE.

<b>London</b> +44 20 7766 4300	<b>Monaco</b> +377 97 97 81 21	<b>New York</b> +1 212 223 0410	<b>Miami</b> +1 305 672 0150	<b>Singapore</b> +65 9665 8990	<b>Beverly Hills</b> +1 310 424 5112	<b>Palma</b> +34 971 495 413	<b>Athens</b> +30 210 967 1661
<b>Dubai</b> +971 4 425 5874	<b>Phuket</b> +66 7623 9739	<b>Hong Kong</b> +852 6496 2094	<b>Tokyo</b> +81 46 738 8612	<b>Sydney</b> +61 499 945 557	<b>Mumbai</b> +91 98211 67253	<b>Shanghai</b> +86 187 0898 6800	<b>Rio de Janeiro</b> +55 21 2553-3238
<b>Aspen</b> +1 970 710 2294							

Advertising of these vessel(s) in printed publications, on the internet or in any other medium is not permitted without prior written permission from Burgess. All particulars are given in good faith and are believed correct but they cannot be guaranteed.

Last updated: 11 February 2025