

# BLISS

---





BLISS

# SPECIFICATION.



Asking price  
EUR 9,500,000



Built  
2009 (refitted 2019), Yachting Developments,  
New Zealand



Length  
36.7m (120.4ft)



Beam  
8.1m (26.6ft)



Draft min/max  
-/4m (13.1ft)



Displacement  
126 tonnes



Cruising speed  
10 knots



Maximum speed  
13 knots



Range  
3,686 nm



Flag  
Cayman Islands



Lying  
West Mediterranean



Class  
GL 100A5



Exterior designer  
Dubois Naval Architects



Interior designer  
Design Unlimited



Construction  
Hull - Composite, Superstructure - Composite



Crew  
5



Guests  
10



Cabins  
3 (1 x double, 2 x double/twin, 4 x additional  
berths)



Engines  
1 x 510hp Caterpillar

[View yacht on website](#)

[Watch yacht video](#)



BURGESS

Discover the difference.  
burgessyachts.com





## BLISS

Main deck convertible lounge/dining area



Lower deck twin cabin



Lower deck double cabin



Galley





BLISS

Main deck aft dining area



Aerial view



At anchor



BURGESS

Discover the difference.  
burgessyachts.com



BLISS

# OVERVIEW.

One of the few sporty composite sailing yachts on the market today, BLISS is the ideal Bucket racer or performance world cruiser. The 36.7m (120.4ft) solent rigged sloop was built in 2009 by the New Zealand shipyard, Yachting Developments. During her recent 2019 refit, she had her main engines rebuilt and her hull freshly painted.

Her sophisticated exterior design and engineering are the work of Dubois Naval Architects. She was a finalist in the 2010 World Superyacht Awards for best sailing yacht in the 30-50m range. The deck layout on BLISS offers many areas to relax, from the large sunpads on the foredeck to the shaded cockpit.

Featuring a flexible contemporary interior by Design Unlimited, BLISS' full beam master cabin can be partitioned to create a smaller master cabin plus a twin bunk cabin. In this mode, the his and hers en suites in the master cabin become an en suite for the master and an en suite for the bunk cabin. Two double guest cabins can be converted to two twin cabins with pullmans to complete versatile accommodation for up to 10 guests in three cabins.

## Key features

---

**High performance composite world cruiser and Bucket racer**

---

**Contemporary Design Unlimited interior**

---

**Accommodation for up to 8 guests in 3 cabins**

---

**Winner of Showboats Design Award**

---

## Tenders

---

Castoldi 16 jet tender, Zodiac RIB with 8hp outboard engine

# MAIN DECK

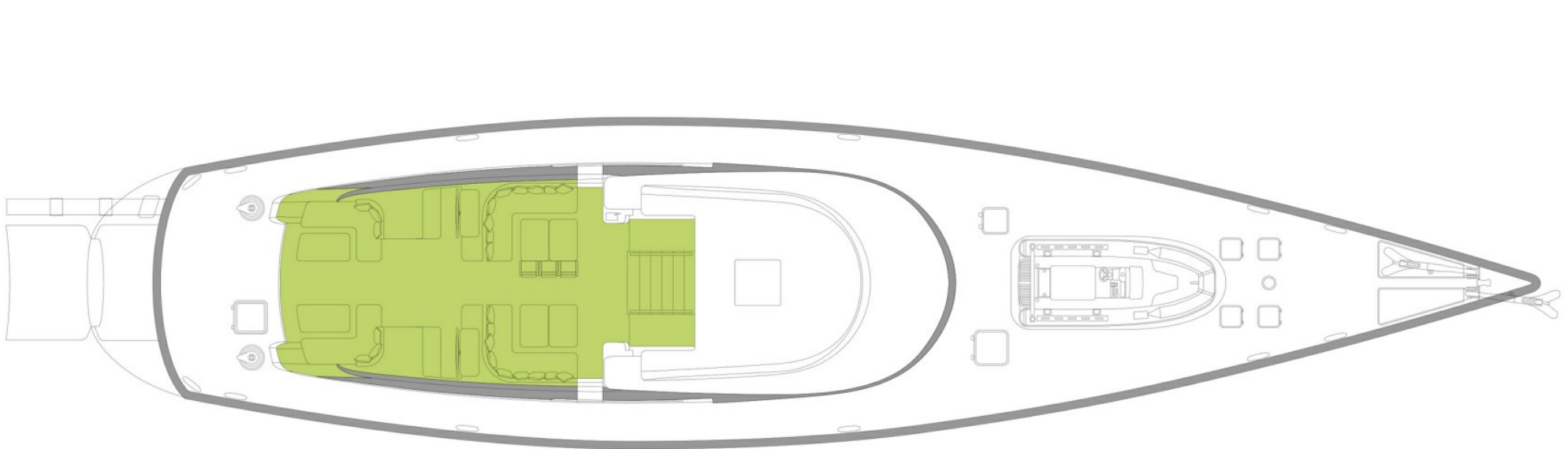

■ GUEST AREAS    ■ OWNER'S SUITE    ■ GUEST CABINS

# LOWER DECK

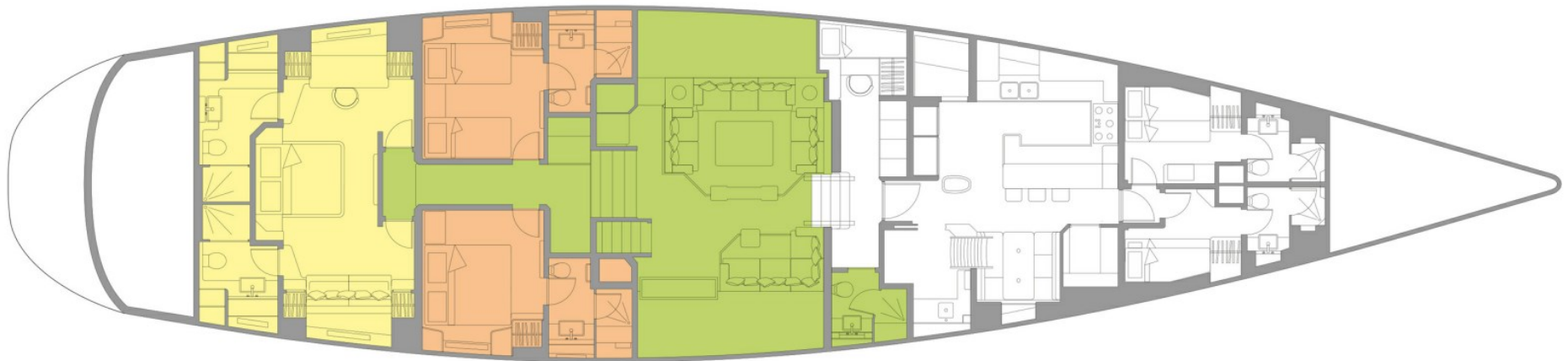

 GUEST AREAS     OWNER'S SUITE     GUEST CABINS



# BURGESS

# WORLD CLASS. WORLD WIDE.

London +44 20 7766 4300	Monaco +377 97 97 81 21	New York +1 212 223 0410	Miami +1 305 672 0150	Singapore +65 9665 8990	Beverly Hills +1 310 424 5112	Palma +34 971 495 413	Athens +30 210 967 1661
Dubai +971 4 425 5874	Phuket +66 7623 9739	Hong Kong +852 6496 2094	Tokyo +81 46 738 8612	Sydney +61 499 945 557	Mumbai +91 98211 67253	Shanghai +86 187 0898 6800	

---

Advertising of these vessel(s) in printed publications, on the internet or in any other medium is not permitted without prior written permission from Burgess. All particulars are given in good faith and are believed correct but they cannot be guaranteed.

Last updated: 23 April 2024