

BELLA VITA



BELLA VITA

APERÇU.

BELLA VITA combines the exhilaration of fast, flat sailing with large, versatile deck spaces and features you'd expect on a much larger yacht.

Prepare for an unforgettably chilled family charter on board one of the best known catamarans in the Caribbean. The relaxed vibe is obvious on stepping aboard, from the light contemporary décor to the warm, welcoming smiles of the crew. A packed toy locker, including a 5.2m tender and scuba diving kit for rendezvous diving, will keep guests' adrenaline levels up all day.

Underway you can see the crew steering and handling lines as you sip cooling drinks in the flybridge lounge and rip along at exhilarating speeds, or you can lie face down on the trampoline watching dolphins play in the bow waves.

At anchor a removable awning shades the flybridge lounge for lunch with a view then you can walk aft and dive off the springboard into gin clear seas. Twin swim platforms make it easy to get back on board then you can ride the crow's nest up the mast for bird's eye views from 30m above the anchorage.

As well as the flybridge lounge, guests can dine outside on the shaded main deck aft and lounge inside in air conditioned splendour opposite the fully equipped bar. At night watch movies under the stars with the yacht's outside projector.

She has four cabins on the main deck, all with plenty of natural light: one master cabin, one double cabin and two twin/double cabins, ideally suited to families and groups of friends.

Principales caractéristiques

Large trampoline for dolphin watching underway

Crow's nest lifts guests over 30m up the mast

Twin fold down swim platforms

Experienced charter crew

Michelin trained chef

Naturally stable at anchor

BELLA VITA

At anchor



Upper deck dining area



Upper deck dining area



Main deck dining area



BURGESS

Discover the difference.
burgessyachts.com



BELLA VITA

Main deck lounge



Main deck lounge



Master cabin



Master bathroom



BELLA VITA

Twin cabin



Twin cabin



Twin cabin



Guest bathroom



BELLA VITA SPÉCIFICATIONS.



Longueur
32m



Chantier
2003 (refitted 2018), CMN Shipyard France,
France



Designer d'intérieur
Chenus Presles & Associates



Largeur
14m



Tirant d'eau min / max
1,8m/2,7m



Déplacement
171 tonnes



Vitesse de croisière
8 knots



Vitesse maximale
13 knots



Consommation de carburant en vitesse de croisière
54 litres par heure



Moteurs
2 x 454hp Caterpillar



Invités
10



Nb de cabines invités
5 (2 x double, 2 x double/twin, 1 x twin)



Équipage
6

[Voir le yacht sur le site](#)



Annexes & jeux nautiques



1 x Tender



2 x Underwater scooters



1 x Kayak



2 x Stand up paddleboards



Wakeboard



Kneeboard



Waterskis



Inflatable tows



Fishing gear



Snorkelling gear

PORT
HULL

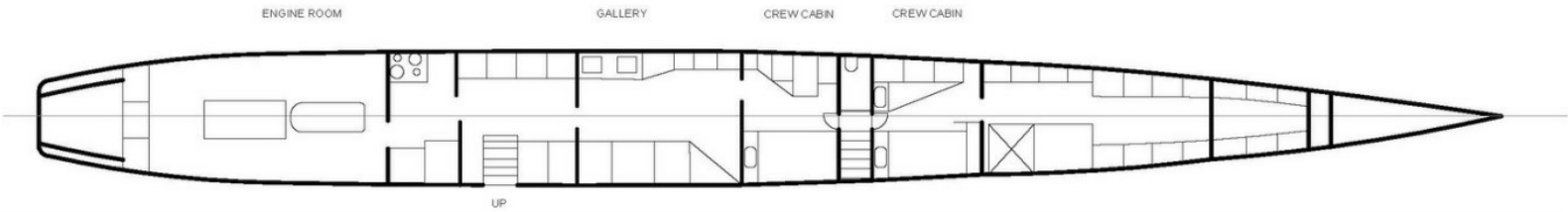

MAIN DECK

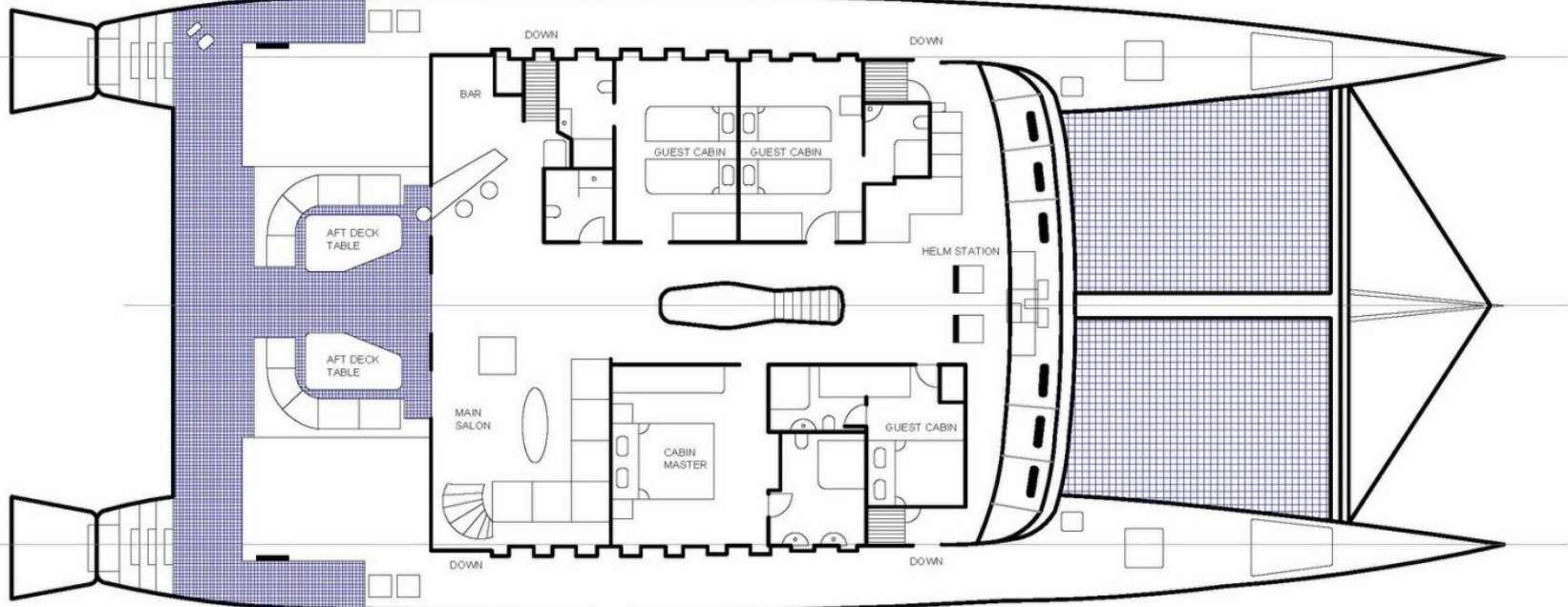
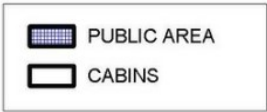

STARBOARD HULL

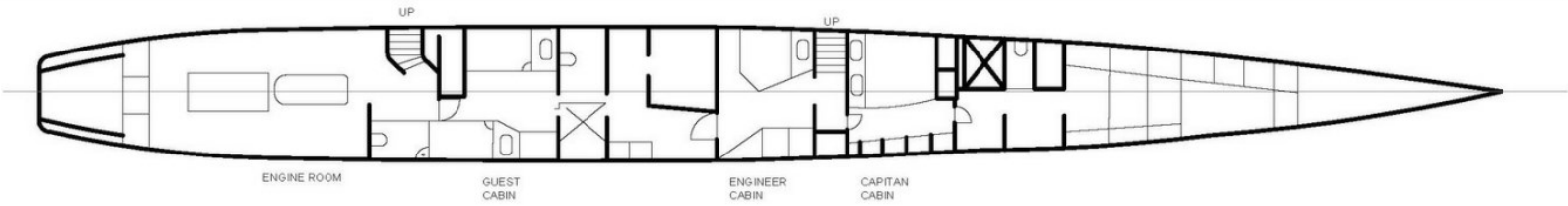

BURGESS

WORLD CLASS. WORLD WIDE.

London +44 20 7766 4300	Monaco +377 97 97 81 21	New York +1 212 223 0410	Miami +1 305 672 0150	Singapore +65 9665 8990	Beverly Hills +1 310 424 5112	Palma +34 971 495 413	Athens +30 210 967 1661
	Dubai +971 4 425 5874	Phuket +66 7623 9739	Hong Kong +852 6496 2094	Tokyo +81 46 738 8612	Sydney +61 499 945 557	Mumbai +91 98211 67253	

La publicité de ce(s) navire(s) dans des publications imprimées, sur Internet ou sur tout autre support n'est pas autorisée sans l'autorisation écrite préalable de Burgess.
Toutes les informations sont données de bonne foi et sont considérées comme exactes, mais elles ne peuvent être garanties.

Dernière mise à jour : 01 mars 2024