

ASYA



ASYA

APERÇU.

Award-winning ASYA is perfect for the discerning charterer who values designer décor and clever use of space, married with state of the art entertainment afloat. The tranquillity of ASYA's zen interior is the theme throughout the yacht, combining pale wood tones and cool metallic finishes with tan leather and cream linen in a layout that balances large lounges with cosy nooks.

Start the day with a soak in your private tub, before finding something cool to wear in your walk-in wardrobe. Your full beam master suite is forward on the main deck which happily gives you uninterrupted peace to begin your day. When you're ready, breakfast is served on the upper deck aft.

As you join your friends and family you are greeted by the scent of baked goods and fresh coffee. ASYA has a customised hull shape that works with the zero speed stabilisers to keep guest comfortable in the four other cabins on the lower deck, and now everyone is raring to start the day.

A swimming platform lowers into position astern and reveals the jetski and tender in the beach club. There is also a SeaDoo, wakeboard, paddleboard and waterskis to try. The yacht has 10 crew, so you know that your charter party of 12 will be well looked after.

A trip ashore is on the cards for some so the 6.8m (22.3ft) Dariel tender quickly ferries them to the quayside for a morning of shopping, sightseeing and local cafés. Each port offers new excitement as your cruise takes you down the coast.

The sun deck beckons those who have promised themselves a morning to top up their tan in the jacuzzi. Few things are as truly relaxing as just whiling the time away in a spa pool with a bird's eye view. Plus a sit-up bar under the hardtop offers refreshment in the shade.

Lunch is a long affair as you all relax into the slower pace of life at sea and enjoy the meal – the rest of the day, and days after that, stretch before you. The sky lounge is just through the full-height glass door, and the ideal spot to watch sports or play backgammon in the heat of the day.

You steal away to the foredeck where a seat for two promises you some time alone with your loved one. Chef is cooking up a storm for dinner later, and you'll meet the others for sundowners in the chic saloon, but right now you take a stroll together on the warm teak deck and know that you are living the ASYA dream.

Principales caractéristiques

Exercise equipment

Jacuzzi on the sun deck

Zero speed stabilisers to reduce any rolling motion while at anchor

Shaded deck dining and deck areas

ASYA

Aerial view



Aerial view



Sun deck



Sun deck aft



BURGESS

Discover the difference.
burgessyachts.com



ASYA

Upper deck dining area



Main deck lounge



Main deck lounge



Main deck lounge



BURGESS

Discover the difference.
burgessyachts.com



ASYA

Main deck dining area



Sky lounge



Sky lounge



Sky lounge



BURGESS

Discover the difference.
burgessyachts.com



ASYA

Master cabin - Main deck



Double cabin - Lower deck



Twin cabin - Lower deck



Lifestyle



BURGESS

Discover the difference.
burgessyachts.com



ASYA

At anchor



At anchor



BURGESS

Discover the difference.
burgessyachts.com



ASYA

SPÉCIFICATIONS.



Longueur
46,7m



Chantier
2015 (refitted 2023), Heesen, The Netherlands



Designer d'intérieur
Bannenberg & Rowell Design



Largeur
8,9m



Tirant d'eau
2,6m



Tonnage brut
499



Vitesse de croisière
12 knots



Vitesse maximale
15 knots



Consommation de carburant en vitesse de croisière
140 litres par heure



Invités
12



Nb de cabines invités
5 (3 × double, 2 × twin, 2 × additional berths)



Équipage
9

Note

Fully licensed for charters in Spanish waters.

[Voir le yacht sur le site](#)



Annexes & jeux nautiques



1 x Tender



1 x Deck jacuzzi



Trampoline



RYA training centre for jetskis
& waverunners



1 x Waverunner



2 x SeaBobs



2 x Underwater scooters



1 x Flyboard



1 x Jetsurf



4 x Kayaks



2 x Stand up paddleboards



Wakeboard



Kneeboard



Waterskis



Inflatable tows



Scuba diving equipment



Snorkelling gear

Remise en forme & bien-être



Abdominal roller



Jump ropes



Resistance bands



Suspension trainer



Training bench



Yoga mats

ASYA

Deck plans

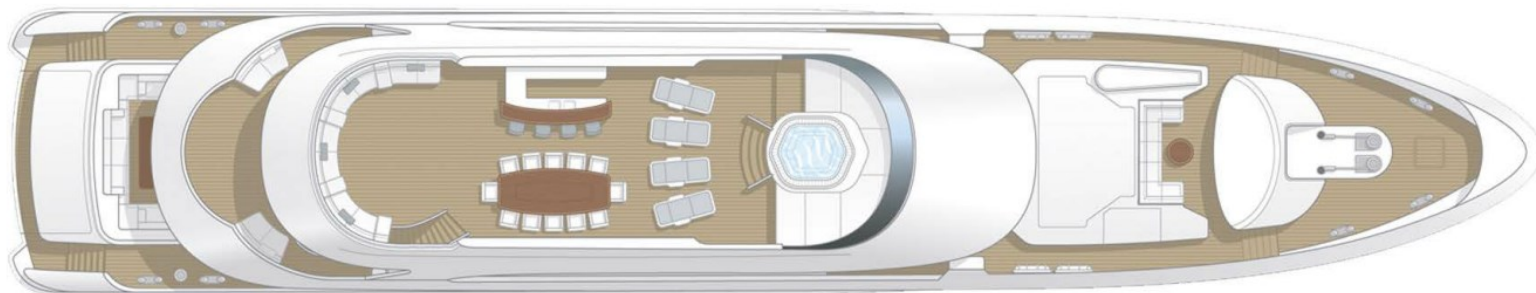
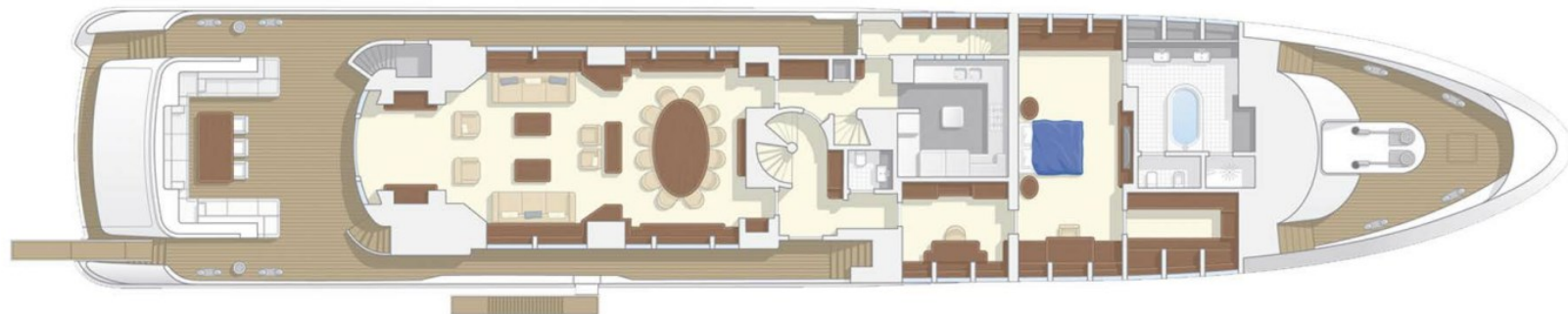
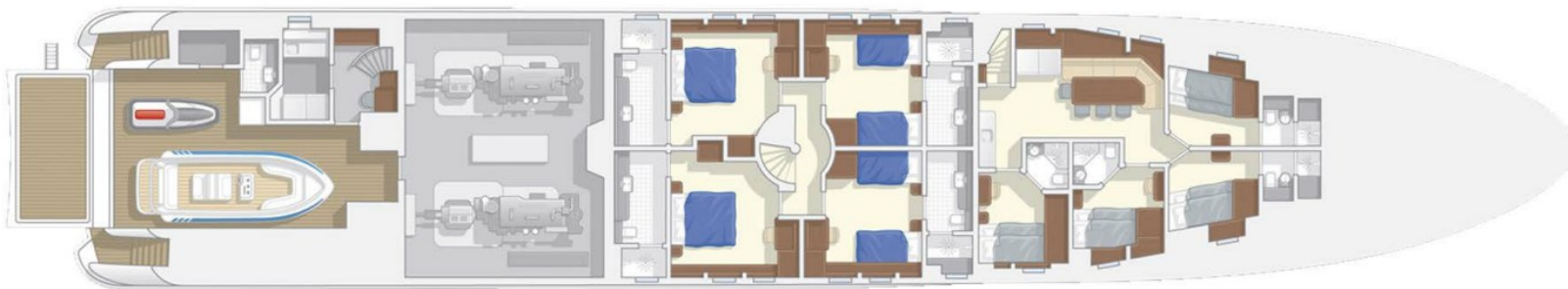

BURGESS

WORLD CLASS. WORLD WIDE.

London	Monaco	New York	Miami	Singapore	Beverly Hills	Palma	Athens
+44 20 7766 4300	+377 97 97 81 21	+1 212 223 0410	+1 305 672 0150	+65 9665 8990	+1 310 424 5112	+34 971 495 413	+30 210 967 1661
Dubai	Phuket	Hong Kong	Tokyo	Sydney	Mumbai	Shanghai	
+971 4 425 5874	+66 7623 9739	+852 6496 2094	+81 46 738 8612	+61 499 945 557	+91 98211 67253	+86 187 0898 6800	

La publicité de ce(s) navire(s) dans des publications imprimées, sur Internet ou sur tout autre support n'est pas autorisée sans l'autorisation écrite préalable de Burgess.
Toutes les informations sont données de bonne foi et sont considérées comme exactes, mais elles ne peuvent être garanties.

Dernière mise à jour : 30 avril 2024