

AQUILA



AQUILA

OVERVIEW.

The largest yacht to be built in the USA since the 1930s, AQUILA has a majestic presence. Built by Derektor, she cruised under the name of CAKEWALK, before being sold and completely refitted. In 2016, Pendennis was contracted to undertake the exterior styling with RWD and Susan Young creating the new interior. Following 12 months of hard graft and over 1,000 people working on the project, AQUILA emerged looking like a completely new yacht.

The 85.6m motor yacht offers an abundance of deck space divided into sections to cater for different occasions. The new forward sun deck offers a large jacuzzi, day bar and treatment room. All four decks aft offer an abundance of space for al fresco dining, relaxing and socialising. AQUILA also boasts a dedicated party deck complete with DJ booth, AV system, smoke machine and light show.

Inside, a cool, calm and contemporary interior creates an aura of tranquillity. Icy silvers, dark browns peppered with nickel and clean whites are accented with patterned soft furnishings and tasteful lighting. The focal piece of the yacht though has to be the 11.2-metre 'waterfall' chandelier which cascades down four levels from the sun deck down to the lower deck creating shards of light across the white marble floor. Other new features include a cinema room, where an enormous 85-inch screen pulls focus. The owner's deck has been completely remodelled too to now offer access to a 60 square metre private deck overlooking the bow. It also offers in addition to the large suite, a massage room, hair salon, his and hers ensuite and study. A further six cabins, plus an extra staff cabin, offer accommodation for 12 guests in total. The yacht offers an exclusive members' club vibe with a gym, two massage rooms and an impressive new bar called 'the London Bar'.

Alongside her impressive deck spaces and stunning interior, AQUILA has a large beach club offering a plethora of fun water toys, ideal for lazy days out at anchor. Her zero speed stabilisers ensure comfort while static and the yacht's 28 crew offer an unrivalled personal service.

Key features

Elevator servicing guest decks - main deck to sun deck

Exquisite London bar on owner's deck

Cinema room with 85-inch screen

Fully equipped gym, with access to the sea, with personal trainer and sunken machines for additional head height

Spa area and massage room, with additional massage room on sun deck

Oversized jacuzzi for 12 guests on sun deck with bar and lounging area

Fire pit on bridge deck for cocktail hour and late evenings

AQUILA

Main deck dining



Cinema on main deck



Owner's deck



Master cabin



AQUILA

Master cabin



Master office



Master bathroom en suite



Owner's deck spa room



AQUILA

Owner's deck lounge

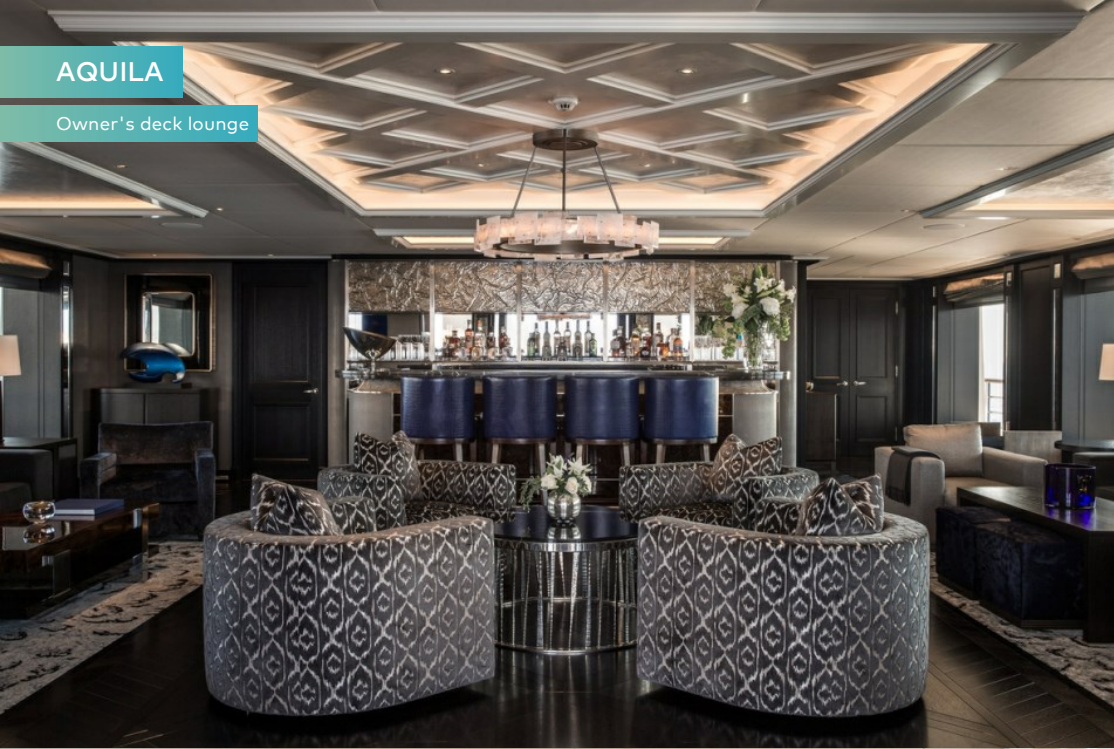

Owner's deck lounge



Owner's deck aft dining area



Owner's deck aft lounging area



AQUILA

Main deck double cabin



Twin cabin



Bridge deck lounge



Bridge deck aft



AQUILA

Bridge deck aft



Sun deck jacuzzi



Sun deck jacuzzi



Sun deck aft lounging area



AQUILA

Sun deck loungers

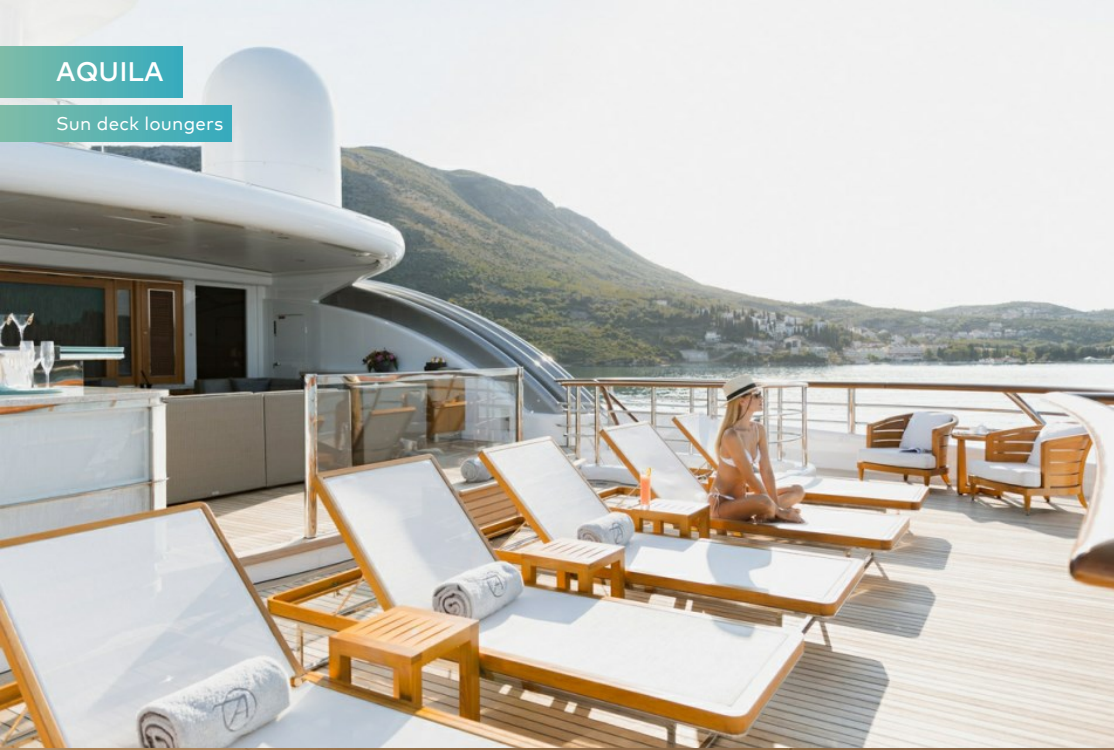

Beach club



Gym on beach club level



Beach club



AQUILA

Beach club and water park



Beach club and water park



Watersports



Beach BBQ set-up



AQUILA

10.1m Riva Aquariva Cento custom tender



10.5m Compass custom tender



At anchor



AQUILA



AQUILA

SPECIFICATION.



Length
85.6m (280.9ft)



Built
2010 (refitted 2016), Derektor Shipyard, United States Of America



Interior designer
RWD



Beam
14.3m (46.9ft)



Draft
4m (13.1ft)



Gross tonnage
2,998



Cruising speed
15 knots



Maximum speed
17 knots



Engines
2 x 3,306hp MTU



Guests
12



No. of guest cabins
7 (5 x double, 2 x twin)



Crew
28

Note

Not available for charter to US residents while in US waters.





















[View yacht on website](#)

[Watch yacht video](#)



EQUIPMENT.

Tenders & toys

- | | | | | |
|---|---|---|--|---|
|  1 x Limousine tender |  2 x Tenders |  1 x Deck jacuzzi |  Waterslide |  Anti-jellyfish pool |
|  Trampoline |  Aquapark |  RYA training centre for jetskis & waverunners |  3 x Waverunners |  3 x SeaBobs |
|  2 x eFoils |  2 x Kayaks |  2 x Stand up paddleboards |  Wakeboard |  Kneeboard |
|  Waterskis |  Inflatable tows |  Fishing gear |  Snorkelling gear |  Air drone |

11.3m Vikal custom limousine tender with 2 x 370hp engines | 10.5m Compass custom tender with 2 x 370hp engines | 10.1m Riva Aquariva Cento custom tender with 2 x 370hp engines | 5.5m Ribeye tender with 1 x 100hp engine | 3 x Sea-Doo GTi - SE 155 Jetskis | 2 x fibreglass kayaks (can be configured as single or tandem) | 3 x SeaBobs | 2 x eFoils | Waterskis | Kneeboards | Wakeboards | Inflatable tows | Snorkelling gear | Aqua park trampoline | Slide (small inflatable) and jungle gym | 2 x Bote inflatable stand up paddle boards | Fishing gear | Ocean pool | Approved RYA training centre for guests' use of personal watercraft | Beach BBQ party set up equipment

Fitness & wellness

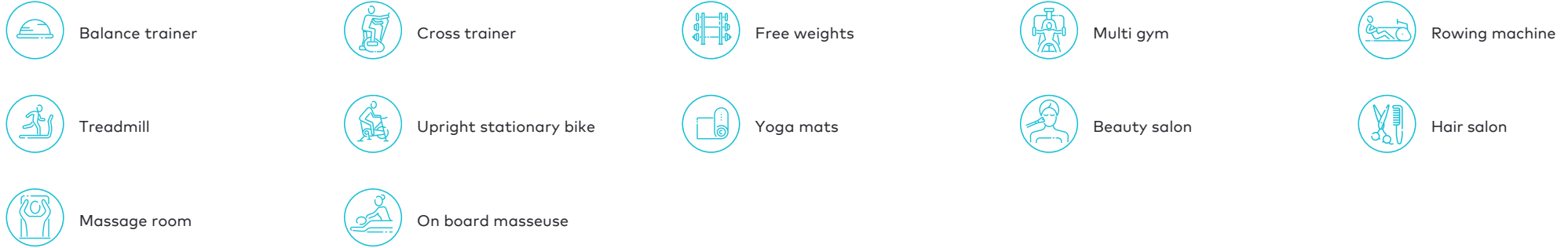

Life Fitness premium cardio machines | 2 x Elevation treadmills | Peloton exercise bike | Flexstrider elliptical trainer | Cybex pro functional trainer | Tonal machine | Pull up bar | Ice bath tubs (one large, three small) | Free weights | Theragun G3 Pro | Mats & medicine ball | Steam shower | Jacuzzi (12 guests) | Spa | 2 x massage rooms | On board beauty therapist/masseuse

Communication & entertainment

Gym | Cinema room | Spa | 2 x massage rooms | Jacuzzi | Disco sun deck set up | State-of-the-art audio visual equipment with movies and music on demand | Cinema room | NEC IP-PBX telephone system, Kaleidescape Movies System - most recent releases downloaded in full HD or 4K for anytime playback | Apple TV - primarily used for air playing guest audio but also have the following streaming services installed: Netflix, Amazon Prime Video, Disney+, Apple TV+, Hulu, Showtime, HBO, Fubo TV, CBS, ESPN+, Philo, NBC Sports

M/Y AQUILA DECK PLANS

SUN DECK

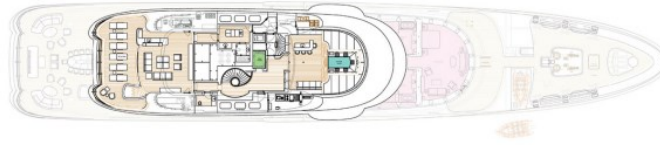

BRIDGE DECK

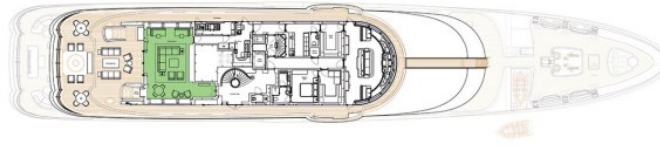

OWNER'S DECK

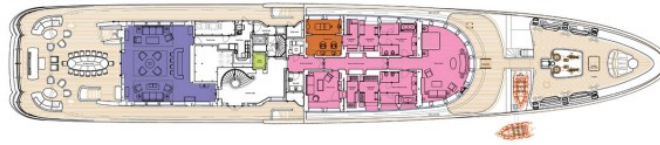

MAIN DECK



LOWER DECK

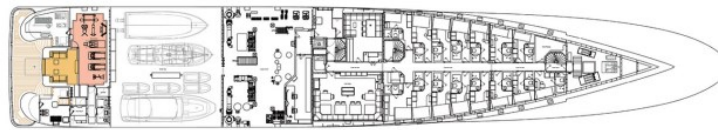

KEY

Living Area	Owner's Saloon	Beach Club	Jacuzzi
Owner's Suite	Guest Cabins	Cinema	Gym
Beauty Salon	Elevators		

BURGESS

WORLD CLASS.
WORLD WIDE.

London +44 20 7766 4300	Monaco +377 97 97 81 21	New York +1 212 223 0410	Miami +1 305 672 0150	Singapore +65 9665 8990	Beverly Hills +1 310 424 5112	Palma +34 971 495 413	Athens +30 210 967 1661
Dubai +971 4 425 5874	Phuket +66 7623 9739	Hong Kong +852 6496 2094	Tokyo +81 46 738 8612	Sydney +61 499 945 557	Mumbai +91 98211 67253	Shanghai +86 187 0898 6800	

Advertising of these vessel(s) in printed publications, on the internet or in any other medium is not permitted without prior written permission from Burgess. All particulars are given in good faith and are believed correct but they cannot be guaranteed.

Last updated: 01 May 2024