

AQUASTION



OVERVIEW.

Welcome aboard AQUASITION. She's a 43-metre (142ft) tri-deck yacht designed for 10 guests in five cabins, with the abundant space, opulent comfort and classic style to make you feel right at home on your holiday cruise as you set sail to explore the coral seas of the Bahamas or Caribbean. Built by the esteemed Trinity shipyard – renowned for its fine traditional craftsmanship – you can expect to find a high standard of finish throughout her luxurious tri-deck interior.

She offers a nice variety of exterior spaces to relax and unwind, socialise or simply bask in in the sunshine on an island-hopping cruise. As she threads her way through barrier reefs en route to a sheltered lagoon, her spacious sundeck is the place to be. Sip a rum punch at the marble-topped bar, float in the jacuzzi pool or recline on sunpad cushions with a panoramic view as the seascape scrolls by. There's also a sociable lounge area up here for larger gatherings and the deck as a whole is an excellent open-air party zone.

There's a snug outdoor space in the Portuguese bridge on the foredeck. This is the place for intimate conversations, with a different vibe from the sundeck above. And when you feel the need for some private time, head on down to the bow where a solitary sunpad with a nest of cushions awaits.

The upper aft deck is another large space, with ample deep, cool shade. There's a large round table where you can dine in style as the sky turns from blue to pink and the sun slips into the sea. The upper lounge opens out onto this deck, so as dusk turns to dark the party can seamlessly carry on at the cocktail bar – or stay outside in the lounge area astern.

The main deck aft is yet another place for groups large or small to gather around a table, with plush armchairs and banquette seats just a few steps from the bathing platform – a great place for everyone to gather for breakfast and perhaps make a plan for the day. The main deck lounge, through wide opening doors, is an elegant space with a refined, traditional charm.

The whole forward part of the main deck level is the master suite. An anteroom with office desk and armchairs leads into the full-beam cabin, furnished and finished in traditional mahogany. There's a huge walk-in closet and a fine, ornate marble bathroom completes the suite. The other four cabins – three king size doubles and a twin – are all nicely finished in the same classic style.

Key features

10m Intrepid towed tender

Shaded deck dining and deck areas

Jacuzzi on the sun deck

Zero speed stabilisers to reduce any rolling motion while at anchor

Exercise equipment

AQUASITION



At anchor



Sun deck



Sun deck



AQUASITION

Sun deck jacuzzi



Bridge deck aft



Bridge deck aft



Bridge deck aft



AQUASITION

Main deck aft



Main deck foyer



Main deck lounge



Main deck dining



AQUASITION

Sky lounge



Sky lounge



Master cabin



Master cabin



AQUASITION

Master cabin study



Master cabin en suit



Guest cabin



Guest cabin



AQUASITION

Tender



At anchor



Lifestyle



BURGESS

Discover the difference.
burgessyachts.com



AQUASITION

SPECIFICATION.



Length
43.3m (142ft)



Built
2010 (refitted 2018), Trinity Yachts, United States Of America



Interior designer
Evan Marshall



Beam
8.5m (27.9ft)



Draft
2.4m (7.9ft)



Gross tonnage
299



Cruising speed
12 knots



Maximum speed
15 knots



Fuel consumption at cruising speed
288 litres per hour



Engines
2 x 1,800hp Caterpillar



Guests
10



No. of guest cabins
5 (4 x double, 1 x twin)



Crew
8

[View yacht on website](#)

[Watch yacht video](#)

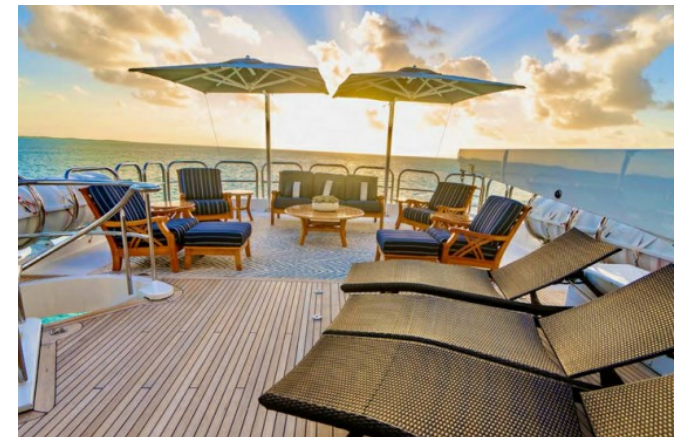

AQUASITION

TENDERS & TOYS



1 × Towed tender



1 × Deck jacuzzi



2 × Waverunners



2 × Stand up paddleboards



Wakeboard



Waterskis



Inflatable toys



Snorkelling gear



Fishing gear

AQUASITION

FITNESS & WELLNESS



Exercise balls



Resistance bands



Yoga mats



AQUASITION

Deck plans

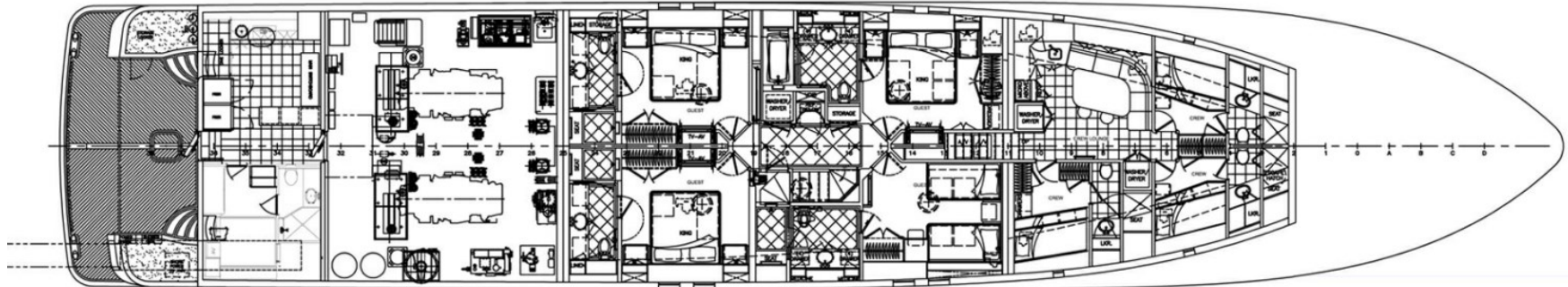
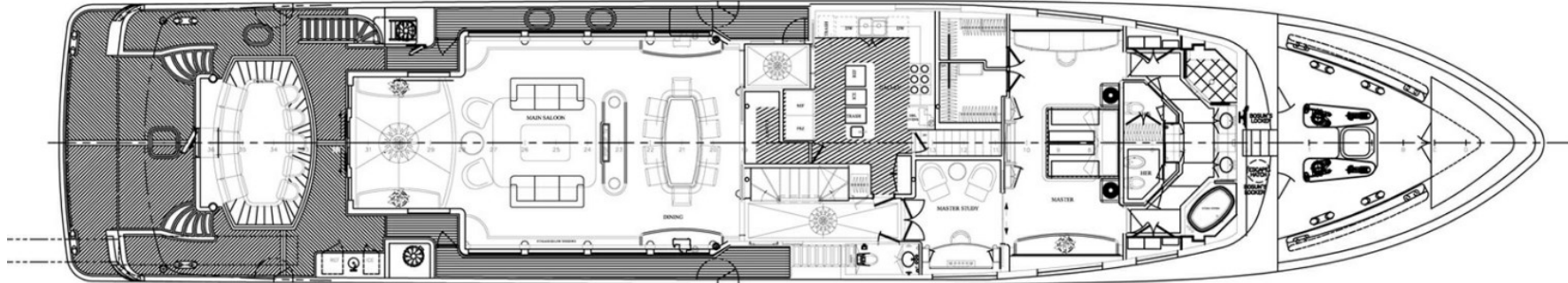
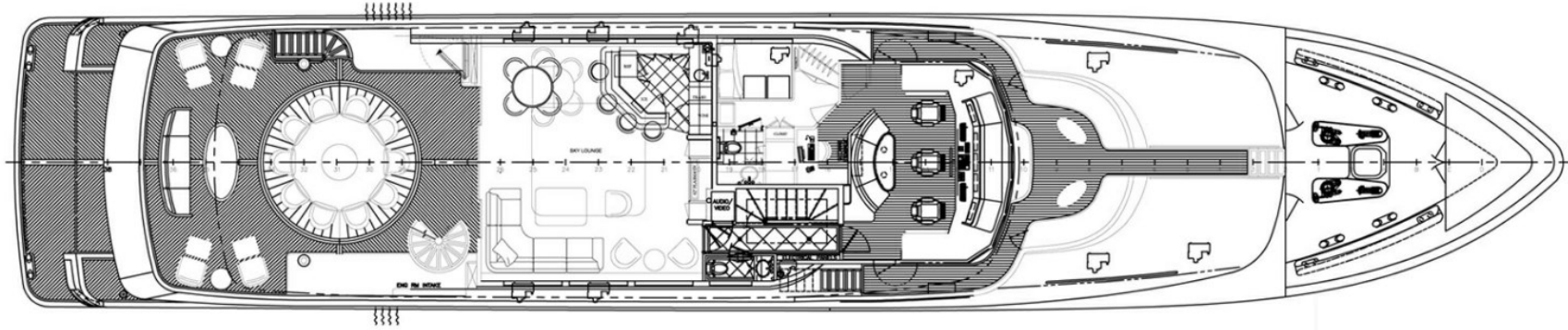
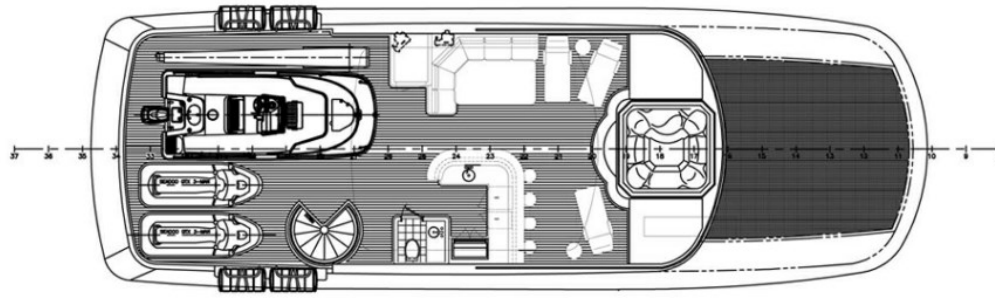

BURGESS

WORLD CLASS. WORLD WIDE.

London +44 20 7766 4300	Monaco +377 97 97 81 21	New York +1 212 223 0410	Miami +1 305 672 0150	Singapore +65 9665 8990	Beverly Hills +1 310 424 5112	Palma +34 971 495 413	Athens +30 210 967 1661
Dubai +971 4 425 5874	Phuket +66 7623 9739	Hong Kong +852 6496 2094	Tokyo +81 46 738 8612	Sydney +61 499 945 557	Mumbai +91 98211 67253	Shanghai +86 187 0898 6800	Rio de Janeiro +55 21 2553-3238
Aspen +1 970 710 2294							

Advertising of these vessel(s) in printed publications, on the internet or in any other medium is not permitted without prior written permission from Burgess. All particulars are given in good faith and are believed correct but they cannot be guaranteed.

Last updated: 28 February 2025