

ALCHEMY



ALCHEMY

APERÇU.

Launched in 2023, ALCHEMY marries striking exterior lines from the naval architects Vitruvius Yachts, penned by Phillipe Briand, with luxurious and modern interior and outdoor areas by Enrico Gobbi and a hybrid diesel-electric powertrain, all delivered by the famously-stylish Rossinavi shipyard.

At 66m ALCHEMY is the ideal size for family charters, with impressive outdoor spaces over four decks offer several lounges and dining areas. When underway, the bridge deck forward makes a good lookout spot. While the beach club and drop-down swim platform are perfect for time on, and by, the water when at anchor. Sit back and watch the children go wild on one of the many inflatables; or join in – there is a very impressive store of watertoys.

For relaxing in the sun, the top deck is a great hangout, with a jacuzzi, loungers and sunpads. Take time for yourself with the yacht's wellness facilities, including a large gym with fitness instructor, spa room and on-board masseuse. ALCHEMY has a young and dynamic crew, with many skills in addition to their yacht crew credentials.

As evening falls, you will want to explore the yacht's wine cellar. There are 230 wines on offer – an opportunity to expand your knowledge and challenge your palette. Ask the chef to create a tasting menu with accompanying wines, to really showcase the collection.

ALCHEMY provides flexible accommodation in six double cabins, one of which can be split into two single berths. The configuration includes a spectacular main deck owner's suite, a VIP cabin on the upper deck and four remaining cabins located on the main and lower decks. A dynamic layout which allows plenty of space and privacy.

ALCHEMY's diesel-electric propulsion means lower fuel consumption, a smoother ride, and less noise and emissions – making your cruising experience even more enjoyable. Her dynamic positioning means you can 'anchor' anywhere you like without even touching the seabed, which reduces the yacht's impact on the marine world.

A yacht of this calibre is in high demand, so get in touch with the Burgess Charter team now to make your booking.

Principales caractéristiques

Young and dynamic crew including spa therapist & Pilates/yoga instructor

Full beam gym with state of the art equipment

Dedicated spa, complete with sauna and waterside access

Large drop-down swim platform

230 bottle wine cellar

Extensive list of water sports equipment including seabobs, e-foils, paddle boards, jet skis and a vast array of inflatables

ALCHEMY

At anchor



Main deck lounge



Main deck lounge



Main deck lounge



ALCHEMY

Master cabin



Master cabin en suite



Master cabin office



Master cabin wardrobe



ALCHEMY

Main deck double cabin



Main deck double cabin en suite



Main deck double cabin en suite



Main deck second double cabin



ALCHEMY

Main deck second double cabin en suite



Bridge deck double cabin



Bridge deck double cabin en suite



Lower deck double cabin



ALCHEMY

Lower deck double en suite



Lower deck double en suite



Lower deck convertible cabin



Lower deck convertible cabin en suite



ALCHEMY

Sky lounge



Sky lounge bar



Main deck aft seating area



Main deck aft stairs to beach club



ALCHEMY

Main deck aft



Bridge deck at night



Sun deck aft BBQ & seating area



Sun deck TV/seating area



ALCHEMY

Sun deck jacuzzi



Gym



Gym



Beach club spa



BURGESS

Discover the difference.
burgessyachts.com



ALCHEMY

Massage room and sauna



Sauna



Golf



Beach club



ALCHEMY

At anchor



Watersports



At night



BURGESS

Discover the difference.
burgessyachts.com



ALCHEMY SPÉCIFICATIONS.



Longueur
65,7m



Chantier
2023, Rossinavi, Italy



Designer d'intérieur
Enrico Gobbi



Largeur
11,3m



Tirant d'eau
3,1m



Tonnage brut
1 194



Vitesse de croisière
12 knots



Vitesse maximale
14 knots



Consommation de carburant en vitesse de croisière
280 litres par heure



Invités
12



Nb de cabines invités
6 (6 x double)



Équipage
16

Note

Not available for charter to US residents while in US waters.

[Voir le yacht sur le site](#)

[Regarder la vidéo du yacht](#)



Annexes & jeux nautiques

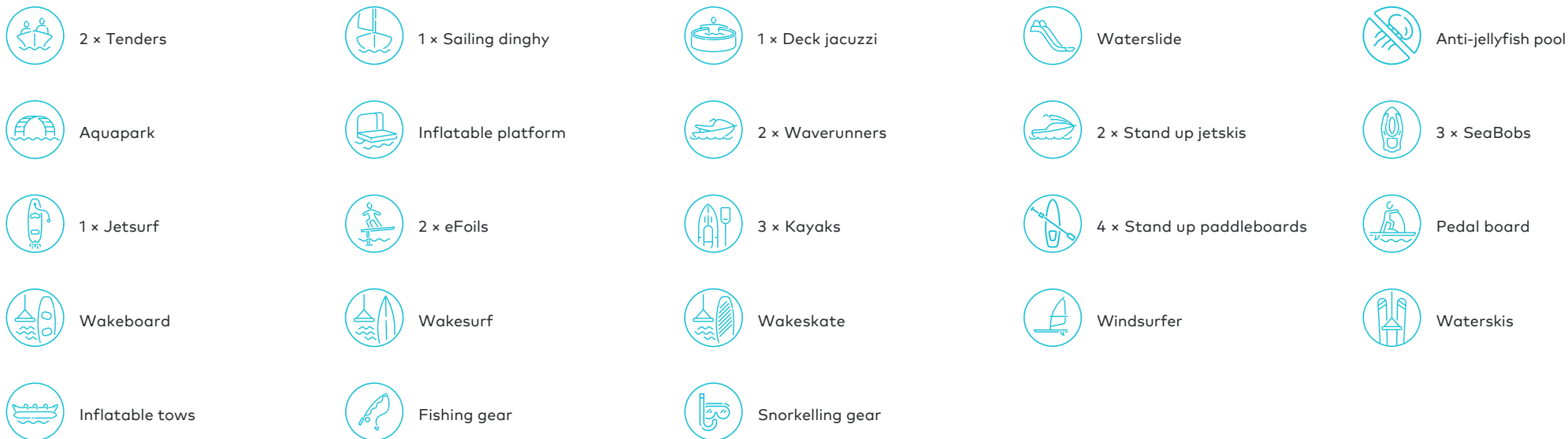

8.5m Castoldi jet tender | 7m Castoldi jet tender | 2 x Sea-Doo Spark jet skis | 2 x eFoil boards | 1 x jet surf board (Ravik Board) | 3 x SeaBobs | 4 x paddle boards | 3 x kayak | 1 x windsurf | 1 x Tiwal 3 (sailing dinghy) | 2 x slalom water skis | 1 x waterski | 1 x trainer waterski | 1 x wakeboard | 1 x wakesurf board | 1 x wake skate | 2 x Hobie Eclipse paddle board | slide | Inflatable mountain/jungle gym | Jelly fish pool | Inflatable island | Inflatable tows including a sofa (4 person) banana (3 person) and donut (1 person) | Jet ski dock | Fishing rods | 4 x mountain bikes

Remise en forme & bien-être

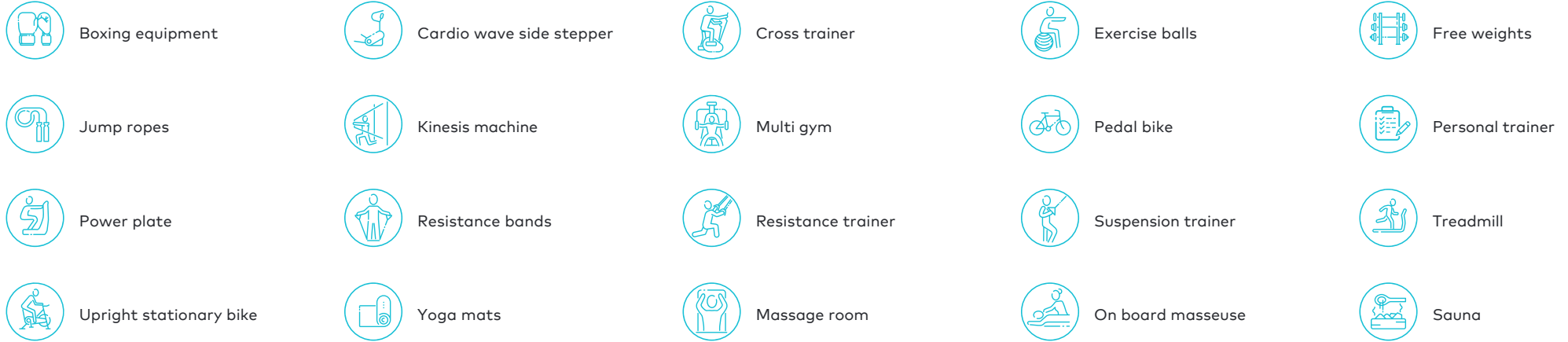

Spa and gym including: Elliptical machine | Technogym bike | Technogym treadmill | Technogym kinesis machine | Free-weights | Kettle bells | Yoga mat

Communication et divertissement

Starlink maritime

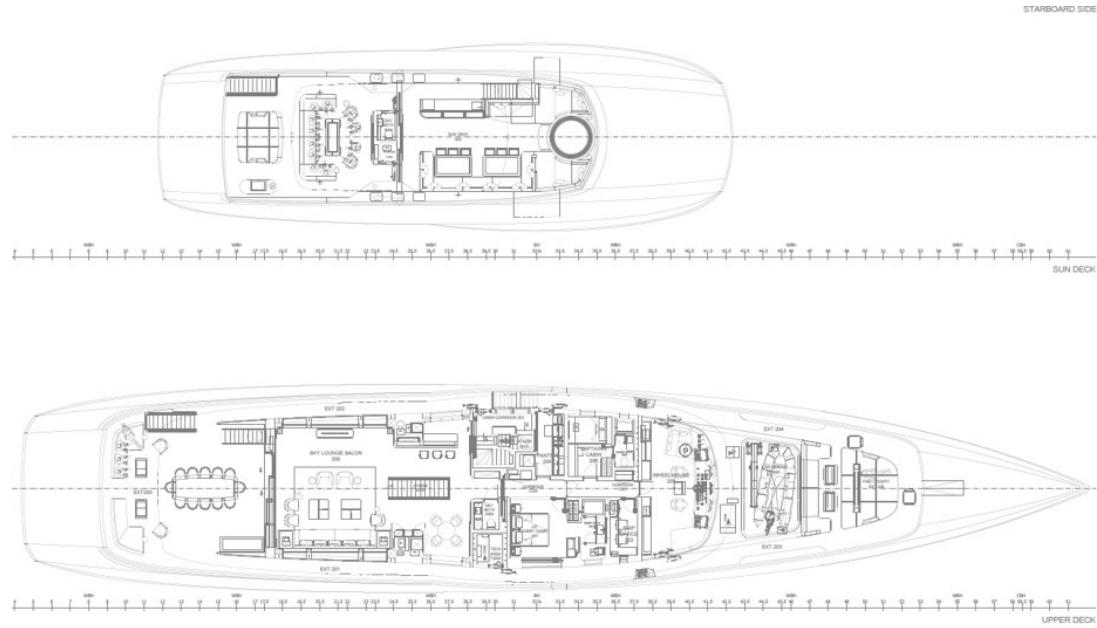

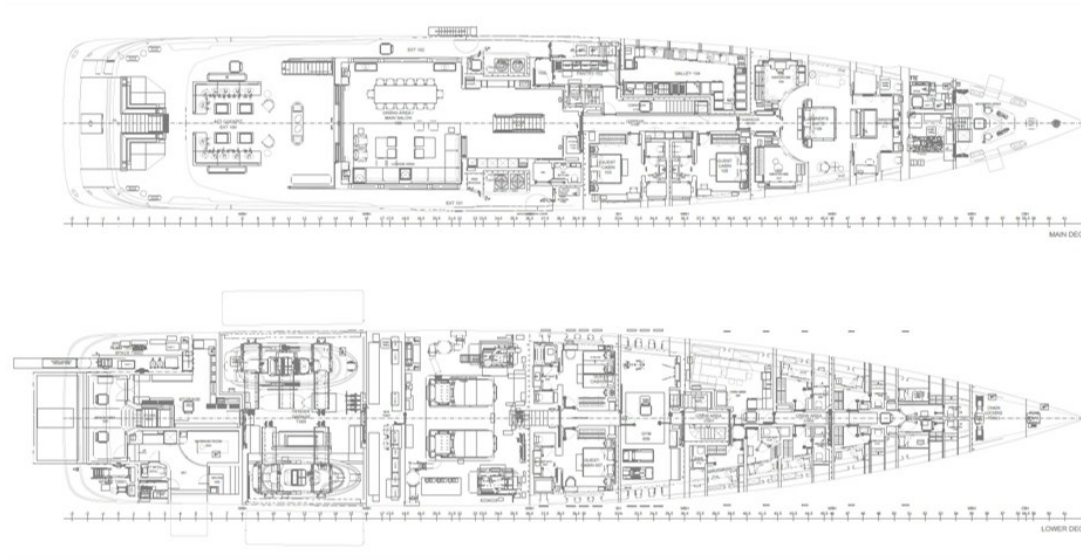

BURGESS

WORLD CLASS. WORLD WIDE.

London +44 20 7766 4300	Monaco +377 97 97 81 21	New York +1 212 223 0410	Miami +1 305 672 0150	Singapore +65 9665 8990	Beverly Hills +1 310 424 5112	Palma +34 971 495 413	Athens +30 210 967 1661
Dubai +971 4 425 5874	Phuket +66 7623 9739	Hong Kong +852 6496 2094	Tokyo +81 46 738 8612	Sydney +61 499 945 557	Mumbai +91 98211 67253	Shanghai +86 187 0898 6800	Rio de Janeiro +55 21 2553-3238

La publicité de ce(s) navire(s) dans des publications imprimées, sur Internet ou sur tout autre support n'est pas autorisée sans l'autorisation écrite préalable de Burgess.
Toutes les informations sont données de bonne foi et sont considérées comme exactes, mais elles ne peuvent être garanties.

Dernière mise à jour : 09 mai 2024