

# AKIKO





AKIKO

# OVERVIEW.

AKIKO is your gateway to explore some of the most unspoilt natural wonders anywhere in the world – the spectacular coasts in and around Australia. This multi-award-winning explorer yacht is absolutely pristine after an extensive refit in 2023, which included a full repaint, hull extension and stem-to-stern interior refurbishment, and her hugely experienced captain and crew know all of the area's best-kept secrets.

With a draft of just 2.4m (7.9ft) and a range of 4,000nm, AKIKO can reach anchorages out of bounds to most yachts, enabling you to get even further off the beaten track where the most seldom-seen spectacles can be witnessed. AKIKO offers an impressive fleet of tenders, selected to suit the destination, to get you right into the heart of the action.

As well as a selection of toys to help you explore, including SUPs, underwater scooters and a jetski (in areas where their use is permitted), there are inflatable tows and surfboards for downtime. She also has snorkelling gear, dive equipment and a compressor for underwater exploration. You'll also find everything you need to go sportfishing and plenty of gym equipment to keep you fighting fit.

AKIKO can also accommodate all sorts of charter parties. She has a full-beam master suite on the bridge deck to ensure maximum comfort by reducing motion sensitivity, facing forward with 180° windows, a full-beam VIP suite forward on the main deck, a lower deck double cabin and two cabins with bunk beds and a single berth.

This is a yacht and crew that enables experiences you will never forget in some of the most untouched landscapes on earth. Adventure, discovery and amazement await.

## Key features

---

Recently refitted with full repaint, extension of the aft deck and interior refit

---

Built to explore remote regions

---

Local guide on board for adventures in the Kimberley region

---

Spectacular full beam master cabin

---

Excellent volume with five cabins and spacious living areas

---

Enormous deck spaces offering complete privacy

---

Experienced captains and friendly crew

---

Zero speed stabilisers to reduce any rolling motion while at anchor

---

AKIKO

Foredeck



Front bow



Main deck aft



Main deck aft





AKIKO

Main deck dining



Main deck dining



Main deck lounge



Main deck lounge





AKIKO

Main deck VIP cabin



VIP bathroom en suite



Staircase



Lower deck double cabin





AKIKO

Lower deck triple cabin

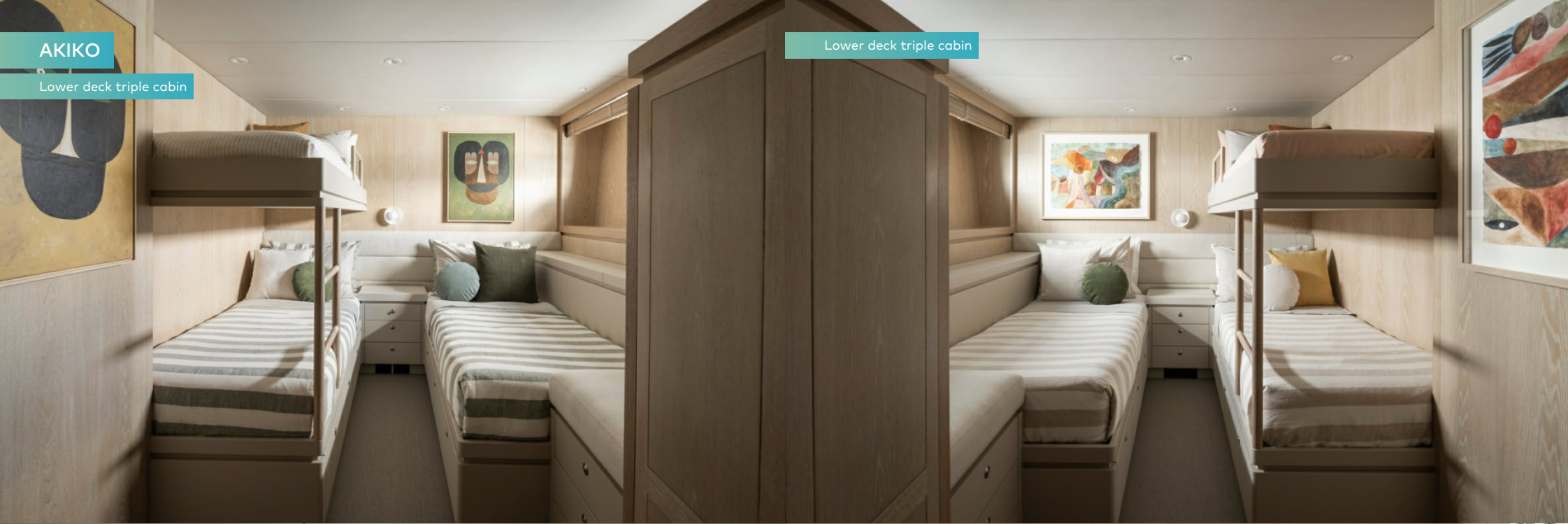

Lower deck triple cabin

Bridge deck master cabin

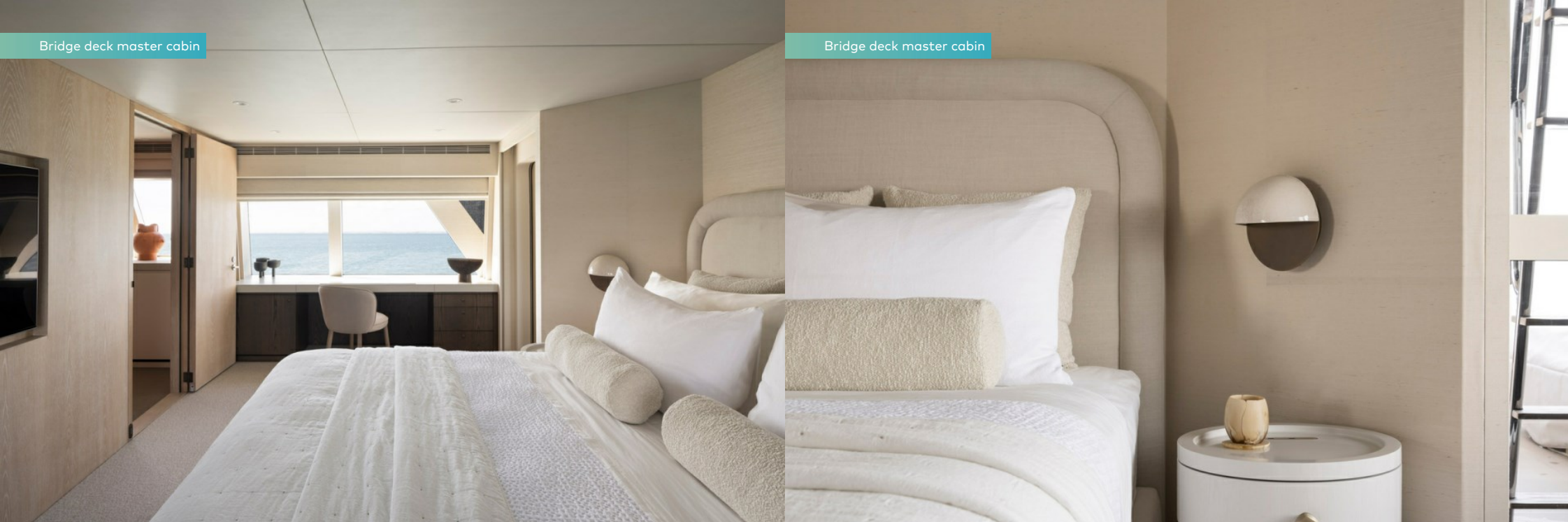

Bridge deck master cabin



AKIKO

Master shower room en suite



Flybridge



Flybridge



Flybridge





AKIKO

AKIKO



Aerial view





AKIKO

# SPECIFICATION.



Length  
34.2m (112.2ft)



Built  
2007 (refitted 2023), Alloy Yachts, New Zealand



Interior designer  
Alloy Yachts



Beam  
7.7m (25.3ft)



Draft  
2.4m (7.9ft)



Gross tonnage  
281



Cruising speed  
10 knots



Maximum speed  
13 knots



Fuel consumption at cruising speed  
90 litres per hour



Engines  
2 x 425hp Caterpillar



Guests  
12



No. of guest cabins  
5 (3 x double, 2 x twin)



Crew  
6

[View yacht on website](#)

[Watch yacht video](#)





## Tenders & toys

---



2 x Tenders



1 x Waverunner



2 x Underwater scooters



2 x Kayaks



2 x Stand up paddleboards



Inflatable tows



Scuba diving equipment



Fishing gear



Snorkelling gear

1 x 7.5m Smuggler RIB tender (2018) - up to 10 guests (local and international charters) | 2 x 5.5m Barra boats (only in the Kimberley, Western Australia) | 1 x 10m Naiad RIB | 1 x 11m Naiad RIB (tenders are subject to location and at an additional charge) | 1 x Sea-Doo RXT-X | Yamaha VX1800A-T jetski (2 man) | 2 x Kayaks (1 man) | 2 x inflatable stand up paddle boards | 2 x Apollo AV-2 Evolution scooters | Extensive fishing and spearfishing equipment | 6 x scuba diving equipment and snorkeling gear | Dive compressor | Inflatable toys \*Note that watersports and toys will vary depending on the cruising location of the charter.\*



# Fitness & wellness

---



Free weights



Upright stationary bike



Yoga mats

Basic exercise equipment located on the bridge deck: Weights (various) | Push up bar | Kettle ball | Yoga mats | Spinning bike

# Communication & entertainment

---

4G and Satellite internet included in the charter fee: Internet via on board Wi-Fi is included where geographically available (MIR (256/256) CIR (128/128)). This is unlimited but not maximum speed. Good for emails. Starlink is available on board. Apple TV, Chromecast, Crestron system and iTunes movie bank (with hard drive capacity for approximately 500 movies), Foxtel (Satellite Television) -- All available in the remote areas --



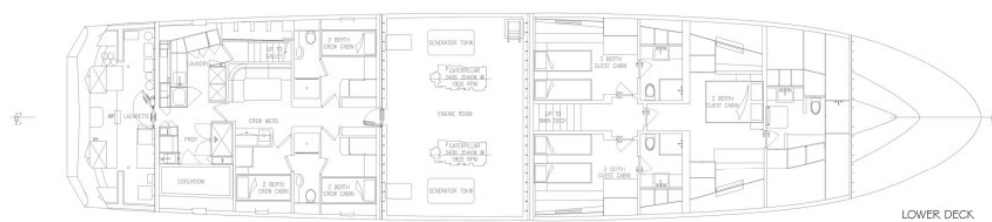
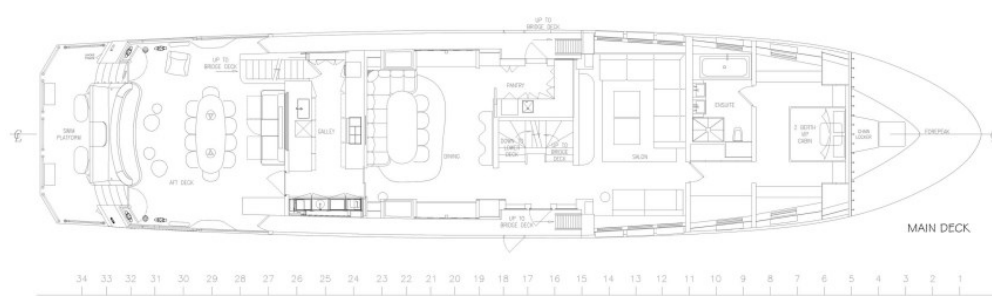
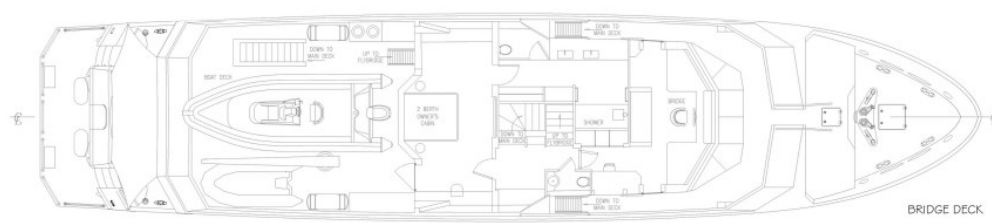
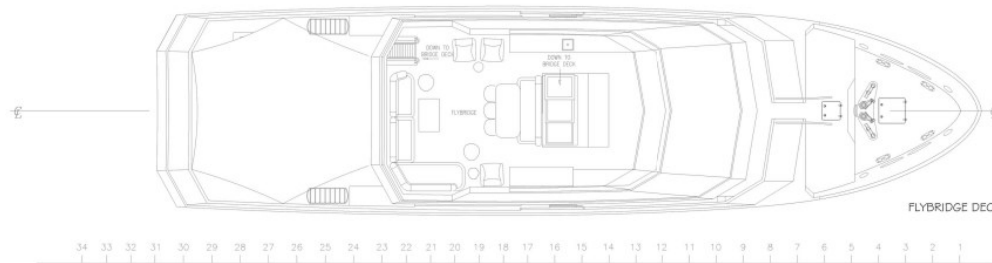

PRINCIPLE PARTICULARS:

LOA	- 34.85m
LWL	- 30.22m
BREADTH WL	- 7.427m
BREADTH CA	- 7.754m
DRAUGHT	- 2.479m

GENERAL ARRANGEMENT FOR MY AKIKO

REV X - AS BUILT  
24-FEB-2023

BURGESS

WORLD CLASS.  
WORLD WIDE.

London +44 20 7766 4300	Monaco +377 97 97 81 21	New York +1 212 223 0410	Miami +1 305 672 0150	Singapore +65 9665 8990	Beverly Hills +1 310 424 5112	Palma +34 971 495 413	Athens +30 210 967 1661
Dubai +971 4 425 5874	Phuket +66 7623 9739	Hong Kong +852 6496 2094	Tokyo +81 46 738 8612	Sydney +61 499 945 557	Mumbai +91 98211 67253	Shanghai +86 187 0898 6800	

---

Advertising of these vessel(s) in printed publications, on the internet or in any other medium is not permitted without prior written permission from Burgess. All particulars are given in good faith and are believed correct but they cannot be guaranteed.

Last updated: 15 April 2024